

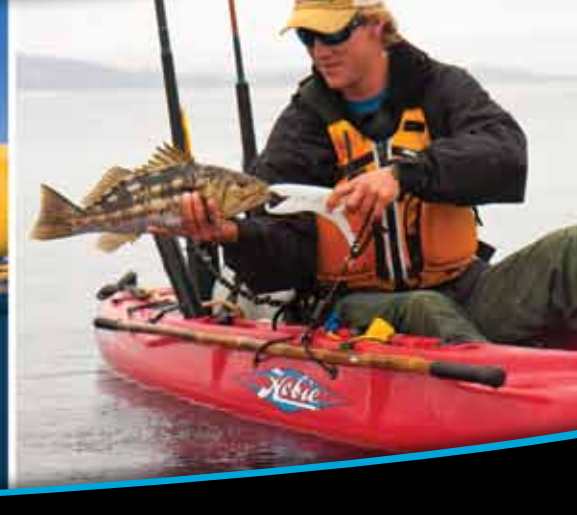

KAYAKING / FISHING PARTS & ACCESSORIES
SPRING 2011





MEET HOBIE ALTER.

Hobie's story starts on a sun-bleached Southern California beach in the late 1940s. Surfing was the underground thing and a wave-obsessed Hobie dreamt of combining his two loves, woodworking and surfing. He started by designing and building Balsa-core surfboards in 1950 in his parents' Laguna Beach garage at the age of just 16, and by 1954 he had opened Hobie Surfboards—SoCal's first surf shop—in nearby Dana Point. Business was good, but Hobie's first serious breakthrough didn't come until 1958, when he and Gordon "Grubby" Clark built the world's first foam-and-fiberglass surfboards. Lighter, faster, and more maneuverable, these revolutionary boards forever changed the sport and put Hobie Surfboards on the map.

Sailing became Hobie's next obsession. Not the stuffy yacht-club variety, but high-speed, high-octane fun that could be enjoyed right off a beach. Employing construction methods honed in his surfboard shop, and studying various traditional multihull designs, the Hobie 14, the world's first fiberglass "catamaran" was unleashed in 1968. This was followed in 1969 by the two-person Hobie 16, which is widely recognized as one of the most important sailboats of all time. Suddenly, high-speed sailing was accessible to everyone, and, thanks to company-organized regattas and now-infamous beach parties; a Hobie lifestyle of fun, family and friends was born. The slogan, "Have a Hobie Day" became a mantra.

Today, Hobie catamarans are as popular as ever but the story doesn't stop there. For the past 40 years we've been advancing design—and fun—in another direction: kayaks.

After carefully considering a kayaker's typical experience, we realized that the paddle was the sport's weak link. The breakthrough came in 1997 with a brilliantly simple yet truly revolutionary idea. Instead of subjecting your arms to a trip to the gym, why not mount fins under the hull and connect them to your kayak via pedals? The MirageDrive®, as this pedal-powered design was dubbed, was a hit and was recognized by Popular Science magazine's "Best of What's New" award in 1998. Suddenly, kayakers could enjoy newfound speed, range and silence. Much like how the Hobie 16 exposed millions of people to the joys of high-speed multihull sailing, the MirageDrive has helped countless kayakers have more fun on the water.



Also in the mid-90s, we began angling for a new market, namely fishing. Compared to powerboats, Hobie fishing kayaks are nearly silent, draw almost no water (allowing users to enjoy skinny-water fishing haunts) and produce zero CO2 emissions or water pollution. Plus, the advent of the MirageDrive freed fishermen to focus on landing their catch, not their paddling. We now make several fishing-specific models, including the Outback, the Revolution® and the new Pro Angler. These boats—like all Hobie kayaks—are designed to meet NMMA certification requirements for flotation.

By the mid 2000s, new kayak models were coming online that fused two of our most successful innovations. The Adventure Island, released in 2006, adds aka crossbars and ama floats and a sailing kit to a MirageDrive-powered kayak, creating a modern version of a traditional Polynesian sailing kayak. In 2010, we introduced our two-man version, the Tandem Island. These boats represent a special co-evolution between our history of designing and building the world's best-loved catamarans, and our desire to create the most innovative and enjoyable kayaks afloat.

The company's newest big idea involved combining the simplicity of an inflatable with the fun of a sailing rig and the ease of a MirageDrive. These inflatable kayaks, introduced in 2007, make kayaking easier, more accessible and infinitely more transportable. In fact, the same fun-minded DNA that made Hobie's first foam-and-fiberglass surfboards so successful is the exact genetic material that makes our kayaks the best ride on the water. Now, even more people can enjoy the Hobie lifestyle.

What's next? With the Hobie Cat Company this could be anything. But given our sixty-plus year history and our dedication to inventing, innovating and improving people's on-the-water experience, you can bet next summer's vacation that it will be big.



LIFE

"The Cat That Flies"
February 6, 1970



ITEM	PAGE
T SHIRTS / HATS / LOGO GOODS	2-3
WATER WEAR	4-5
LIFE VESTS / PFD	6-7
SAFETY	7
Hobie eVolve Electric Motor Kit	8-9
SIDEKICK AMA	10
ST TURBO FINS	10
SUN BIMINI / DODGER	12
SAILING KITS	14-15
ISLAND TRAMPOLINES	15
DRIFT CHUTE	16
ANCHOR TROLLEY	16
ROD LEASH	16
STAKEOUT POLE	16
ACCESSORY PACKS	16 & 23
ROD HOLDER EXTENSIONS	17
LIVWELL	18
HATCHES / GEAR BUCKETS	19
DRY BAGS	19
FISHING ROD HOLDERS	20-23
ELECTRONICS	24-25
COMPASS	24
DOLLY CARTS	26
TRAILER	27
STORAGE BOX	27
RACK PADS / STRAPS	27
MIRAGEDRIVE BAG	28
COVERS / BAGS	28-29
MISC ACCESSORIES	30-31
REPAIRS / MAINTENENCE	28-31
TOOLS	31
HARDWARE	31-33
KAYAK SUPPORT	35
KAYAK FAQ	35
WARRANTY INFO	35
LIVWELL PARTS	35
PARTS DIAGRAMS	35-44
NUMERICAL PARTS LIST	45-48

Note: Freight to dealers is not included in pricing.

No portion of this catalog may be reproduced without the express permission of the Hobie Cat Company. Printed in USA.
All rights reserved. ©2011 Hobie Cat Company. Oceanside, CA 92056

HATS WITH "HOBIE FISHING" 5023PP / 5023TO / 5023TS / 5023VS

5023TS
Boa

5023TO
Oar Washed

5023PP
Pumpkin

5023VS
Visor

5019BK
6 Panel Low Pro

5018BK
Black

5018GM
Gray Mesh

5018TG
Tan Green

HOBIE HATS Hats with Hobie "H" in contrasting color and "Hobie" on the side. Mesh versions are breathable and made from 100% Polyester. Others are 100% Cotton Brushed Twill. All but Blue/Gold have embroidered logo raised and back shadowed.

5019BK Black Low Pro

5018BK Black

5018GM Gray Mesh

5018TG Tan Green

5018RM Red Mesh

5018BL Blue

5018RM
Red Mesh

5018BL
Blue

LID LATCH

Don't let that fancy new hat blow away. Secure it to your shirt or life vest with a Lid Latch.

1553L



5130xx Hobie Mirage Kayaking (Gray)



5129XX Hobie Mirage Kayaking (Black)



5131xx Hobie Mirage Fishing (Tan)



HOBIE "T" SHIRTS All shirts are 100% cotton with screened graphic designs on the back and chest.
(xx = size) md, lg, xl [xxl available in fishing version]

HOBIE SUNGLASSES

Hobie® Polarized Sunglasses are designed to improve your vision by eliminating glare, a problem that has been around since the first sunrise. Once you wear Hobie sunglasses you will never want to be without them! By cutting all glare, our sunglasses make it easier to see the wind on the water, the fish in the water and any obstacles in your way. When you put on Hobies it's like a vacation for your eyes! See the complete line of Hobie Sunglasses at hobiepolarized.com



PLAYA - 1562BLK



Escondido- 1565BLK



Boomer - 1564BLK



HOBIE CROAKIES

Keep your glasses in place! Made from wetsuit fabric that will not stretch or lose shape when wet. Remains secure whether worn normally, raised, or lowered.

1553CR Each



BOOK - FROM PENGUIN WINGS TO BOAT FLIPPERS

Great book about taking ideas from nature to use in products. All about the Hobie Mirage pedal system. Written by Toney Allman from the series "Imitating Nature".

615 Each



HOBIE KEY FLOATS

Don't lose those keys! Keep a few bucks dry, inside the small compartment, while on the water.

72010 Each



HOBIE FISH THE WORLD DVD

Join us as we fish Australia, France, Holland, the Oxbows of the Mississippi, the Lower Owens in the Eastern Sierras, the Louisiana bayous, North Carolina, Corsica, and down the west coast of Baja Mexico.

84431001 Each



SPORTS BOTTLE

Show your Hobie spirit with the "just right" size sports bottle.

71999011 16oz

71997001 18oz

71998001 32oz

(Check parts pages for correct bottle fit)



STAINLESS WATER BOTTLE

71995001 20oz

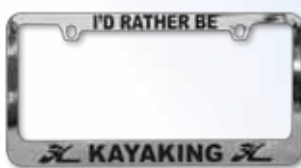

LICENSE FRAME "KAYAKING"

3044 Chrome



LICENSE FRAME "HOBIE"

3043 Chrome



12451031 / 12451021



12451050 / 12451051



36601000 / 36601011 / 13001001



12453021



12453011



12453031



79545001

STICKERS

12451031 "Hobie Diamond" Turq 36"

12451021 "Hobie Diamond" Red 36"

12451050 "Script" Black 24"

12451051 "Script" White 24"

12453011 Hobie Kayaks 5 1/2"

12453021 Hobie Kayak Fishing 5 1/2"

12453031 Hobie "Teq Sunrise" Dome 4 1/2"

13001001 Hobie "Flying H" Black 12 5/8"

36601000 Hobie "Flying H" Black 6"

36601011 Hobie "Flying H" White 6"

79545001 Hobie "H" Dome 2 1/4"

HOBIE WATER WEAR - CLOSEOUTS

Be more comfortable and extend your kayaking / sailing season by dressing appropriately for the conditions. Mix and match layers to get the comfort you desire. Hobie water wear is designed for both kayaking and sailing needs.



HOBIE SPRAY TOP

Designed for active kayaking and sailing. Can be worn with swim trunks or over a wetsuit. Mix and match layers to get the comfort you desire. Spray and wind protection. Beautiful styling and extra durable construction. Construction Features: Neck and wrist seals, Neoprene waist seal, Breathable 5000cm3 nylon shell, Offset chest pocket, Arm patch pocket.

HOBIE SPRAY TOP

Limited to 3850SM / 3850LG



HOBIE "SHORTY" WETSUIT

HOBIE "SHORTY" WETSUIT

2mm/2mm Great comfort for spring-like conditions. Add the Hobie Spray Top to further extend the cool weather comfort range. Add a rash guard for chafe protection. Vertical back zip entry.

HOBIE - SHORTY 2/2 BLACK

3855SM / 3855MD / 3855LG / 3855XL

HOBIE - SHORTY 2/2 RED/BLACK

3853SM / 3853MD / 3853LG / 3853XL

FEATURES: Anti-choke neck, Armortex seat, Lumbar Flex Zone.

CONSTRUCTION: 100% Dura Flex with mesh chest and back panels, Glued, Blindstitched seams.



HOBIE "FULL" WETSUIT

HOBIE "FULL" WETSUIT

3mm/2mm For colder days. Add the Hobie Spray Top to further extend the cold weather comfort range. Add a rash guard for chafe protection. Vertical back zip entry.

HOBIE FULL WETSUIT - 3/2 RED/BLACK

3854LG / 3854XL

HOBIE FULL WETSUIT - 3/2 BLACK

3856MD / 3856LG

WETSUIT SIZE CHART

MEN'S SIZE		HEIGHT		CHEST		WAIST	
EURO	USA	Ft/In	Cm	In	Cm	In	Cm
48	S	5'7" - 5'9"	171 - 177	37-40	94-101	30-32	76-83
50	M	5'9" - 5'11"	175 - 181	39-42	99-106	32-34	81-88
52	L	5'11" - 6'1"	179 - 186	41-44	103-110	34-36	86-93
54	XL	6'0" - 6'2"	183 - 189	43-46	108-115	36-38	91-98

THE VISICARBON PRO™ combines a high visibility light and safety flag with a light weight, low drag, and portable style. Insert foam base into molded-in or Live Well rod holders.

A quick look at the features:

- The ultra thin mast and redesigned flag combine to offer excellent performance with low wind drag.
- Main mast section designed with carbon fiber tubing for high strength and ultra light weight.
- The VISICarbon Pro™ weighs in at just 14 ounces, complete with 3 AA batteries.
- The 48" long VISICarbon Pro™ breaks down to 14" long in seconds.
- The Silent Snap™ flag attachment system provides a secure attachment that allows the flag to be removed in seconds.
- The folded unit can be stored inside the nylon flag which doubles as carry bag.

72020040 SAFETY FLAG/LIGHT COMBO



SAFETY FLAG Be Seen! When out on your kayak, you are very low to the water. Add to that any wave or swell action and you are often hidden from other boaters view. The 4' tall safety flag will help other boaters see you. Very important in areas with mixed boating traffic! For mounting in areas with internal access, you can use large washers and the provided nuts for mounting. Otherwise, in areas with no internal access, use the mount which includes bolts and well nuts.

72020002 SAFETY FLAG 4'
72020012 DELUXE MOUNT

MOUNT

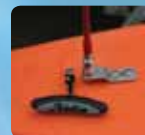

TELESCOPING

PADDLE is a good spare paddle that can be stored within most Hobie kayak models. 6 1/2" wide blade will fit into an 8" hatch opening. Measures just 20" in closed position (45" when fully extended). Lightweight, easily portable yet with durable construction of high grade plastic paddle and anodized aluminum shaft. Corrosion resistant design. Floats too!

3091 Each



BILGE - HAND PUMP Water over the bow while you have a hatch open can leave you with a flooded hull. This light weight pump is security for long trips on the water. Features super-comfortable, easy-grip rubber overmolded handle and a high-visibility neon yellow stock for extra safety.

72020032 BILGE - HAND PUMP

HYDROSTAR - S.O.S DELUXE "HOBIE"

Whether you're paddling, sailing, camping, fishing, hunting or just changing your tire the Hydrostar offers an unmatched combination of features that makes it a must-have for all your water sports, outdoor and travel needs. Everything you need for lighting in one compact waterproof package.

Hydro Star Features:

2-way LED FLASHLIGHT
Emergency XEON STROBE
Programmed S-O-S SIGNAL
Waterproof up to 50 feet

Suction cup base
Strong magnetic base
Twist action control switch
Safety leash
Batteries included

72020003 HYDRO STAR SOS LIGHT



HOBIE GLOVES

Protect your hands while increasing your grip strength. Gloves add grip strength on lines which can ease up on the amount of force you need to exert. Available in

small, medium, large & extra-large. (xx = size)

3188xx Hobie Glove



THUNDERWEAR COLD WEATHER GLOVES

Full fingered glove for watersports. Made of Neoprene and Thunderhide, an amazing synthetic leather that is completely wettable and

washable. Keeps your hands warm. These gloves run large and are men's sizes. (xx = size - XXS/XS/SM/MD/LG/XL)

3187xx Gloves

RONSTAN GLOVES

'Amara' synthetic leather for maximum durability, minimum stretch and shrinkage. Double Aramid stitching in high wear areas. Double thickness palm and fingers for protection and grip. UPF 50 (Ultra-Violet Protection Factor). Mesh panels for flexibility, comfort and quick drying. Low cut neoprene wrist band for secure fit and clear access to start watch. Sticky gloves reduce fatigue by minimizing the physical effort required to hold rope. (xx = size XS/SM/MD/LG/XL)



RONSTAN SHORT FINGER GLOVES

RF4850xx Short Finger Glove



RONSTAN THREE FINGER GLOVES

RF4851xx Three Finger Glove

**HOBIE HI-BACK MESH** by Stohlquist

This front entry vest was designed just for Hobie Kayaks! The flotation in the back is up high and away from the seatback (less bulk down low). Short length does not "ride up" around your neck when you are sitting. There is a mesh panel across the back. Front zip entry for easy on and off. A zipper keeper to prevent the zipper from slipping down when in use. Large mesh pockets on the front for easy storage and access of small items. Stretchy neoprene adjustable padded shoulders. Ventilated mesh side panels. High waistline cut. Huge arm cutouts and a short waist allow excellent freedom of movement. Adjustable side straps offer enough size variation for many layers underneath or none!

SMD / LXL / XXL (Mango Yellow or Forest Green)

S6143xxx Mango (xxx = size)

S6144xxx GREEN (xxx = size)

(UL - Approved) for use in USA Only

S6145xxx ULC - Mango (xxx = SMD / LXL)

(ULC - Approved) for use in Canada Only

S6143-4-5 Sizes (Chest): SMD 30" - 42"
LXL 42" - 52" / XXL 30" - 54"



**BACK FLOTATION
ABOVE SEAT BACK**

**WOMENS HOBIE HI-BACK** by Stohlquist

Many of the same features as the Hi-Back Mesh, but shaped and contoured specifically to fit Women. Foam layering inside the vest is countoured for a better fit. XSS - MLG - PS

S6146xx POWDER BLUE (xx = size)

S6147xx MANGO (xx = size)

S6146 Sizes (Chest): XS/S 30" - 36"
M/L 36" - 42" / Plus Size 40" - 46"

HOBIE SHORT-PROFILE VEST by Stohlquist

This side entry design has set the standard for streamlined pfd fit. Cool mesh side panels and reflective accents. Stretchy neoprene adjustable padded shoulders. Roomy mesh pocket with "D" ring for keys. Ventilated mesh side panels. High waistline cut. Huge arm cutouts and a short waist allow excellent freedom of movement. Extra short length does not "ride up" around your neck when you are sitting. Adjustable side straps offer enough size variation for many layers underneath or none!

SM / MD / LG / XL / XXL

(UL - Approved) for use in USA Only

S6142xx (xx = size)



S6142 Sizes (Chest): Small 32" - 36" / Medium 36" - 40"
Large 40" - 44" / XLarge 44" - 48" / XXL Large 48" - 52"

**STEARNS' CHILD/YOUTH VESTS**

Our children's life vests meet the same functional requirements as those for adults. We've selected the, easier to put on, three clip model. These are easy to adjust for different size crews.

(Vest colors vary)

SBV3120YEL 30 to 50 lbs

SBV3122YEL 50 to 90 lbs

HOBIE HI-BACK FISHERMAN by Stohlquist

Ready and loaded, this new fishing and hunting vest is the ideal PFD for the sit-on-top kayaker, providing comfort and water safety with all the necessities, close at hand. Put to work, while you play, the FISHERMAN provides excellent cockpit management with places for the little things like pliers and extra tackle. The EVA front pockets fold down to provide a work station and are sized to fit small tackle boxes. The FISHERMAN'S outer platform provides mounting locations for tippets, retractors, nippers, leader-line, hemastats, and pliers. Choose between low-vis Cactus color or hi-vis Mango with 3M reflective strip. Safety, comfort, storage and utility make this the ultimate vest for fishing or hunting.

The Drawbridge...dual front-mounted tool pouch pockets have protective EVA stiffened outer shells to protect pocket contents when re-boarding the kayak from "over the rim".

- EVA inner platform - is a fold-down work surface.
- Velour (hook & loop style) -inner lining attachment surface.
- Sized to fit small plastic lure boxes.
- Inside accessory pockets and stowage for tools.

Outer Platform....like an angling vest, the FISHERMAN vest has mounting locations for tippets, retractor(s), nippers, leader-line, hemastats, and pliers.

FEATURES:

- Choose low-vis Cactus color or hi-vis Mango with 3M reflective.
 - Open sides for ventilation.
 - Neoprene padded shoulders and lower back waistband.
 - 1-1/2" webbing belt with dual side adjustments.
 - Multiple pockets, all with drainage.
 - High-back flotation rides above back rest.
 - Adjustable 1-1/2" webbing shoulder and side adjustments.
 - Cinch harness adjustment for zero ride-up.
 - New PVC-free Gaia foam.
- SMD / LXL / XXL (Cactus / Mango)
S6149xxx Hi Back Fisherman Cactus (xxx = size)
S6148xxx Hi Back Fisherman Mango (xxx = size)
 (UL - Approved) for use in USA Only

SAFETY TIP!

LIFE VESTS Get a good, comfortable life vest and WEAR IT! A life vest does you little good stored on your boat, especially if you get tossed into the water and away from your boat. Accidents happen and by their nature, they happen when you are not prepared. A life vest can keep you afloat until you can rescue yourself or you can be rescued by others. In the worst cases when injuries or cold water are involved, your life vest can make all the difference! Be sure everyone onboard your boat wears a life vest too! Pass the word! Federal law now requires that all persons below the age of 13 must wear a life jacket while aboard a boat.

**HOBIE INFLATABLE PFD**

Light weight and comfortable. Ready when you need it, manual CO2 inflation or buy mouth inflator allows for swimming, wading and intentional immersion.

Available in Red/Grey or Tan/Grey.

S6779RG RED / GREY

S6779TG TAN / GREY

- Buoyancy: 26 Pounds
- Inflator Type: Halkey Roberts 3F
- Primary Inflation: MANUAL
- Auxiliary Inflation: Oral
- Size and U.S.C.G. Wearer Requirements
- Adult Universal: For persons 16 years or older, weighing more than 80 lbs., with chest size of 30 - 52 inches
- U.S.C.G. Approval Type: U.S.C.G. Type III
- Durable Ripstop Nylon Front Shell
- Waist Belt Width: 1"
- Zippered External Pocket

**INFLATABLE BELT PACK PFD**

Extremely lightweight and comfortable belt carried PFD design is cooler and more comfortable than typical PFDs. Functional design for multiple types of water sports from fishing, kayaking, sailing to stand up paddling (SUP). Belt pack style stays out of the way till you inflate and put the bladder on over your neck. Adjustable waist. Buoyancy: 26 Pounds. USCG Approved Type III PFD, approved for use by persons 80 lbs and 16 years of age or older. Size: Universal Adult Size. Durable ripstop nylon pack. 2" wide, adjustable, nylon waist belt. Includes (1) CO2 Cylinder and instructions.

S6780RG RED/GRAY

S6779R PFD INFLATABLE REARM KIT



HOBIE eVOLVE v2 POWERED BY TORQEEDO

Whether you're augmenting your MirageDrive or using the Hobie eVolve as your primary power source, this quiet and efficient electric motor will dramatically expand your horizons. Maybe there's a ripping tidal current or a series of fast-flowing eddies that you must negotiate before reaching that pristine shoreline. Maybe it's a bay that's always been a little too far explore. Or maybe it's just been a long day and your tired muscles could use a break. Either way, the clean, quiet, eVolve system is there for you.

This tidy German-engineered electric motor kit fits any MirageDrive kayak and it comes with two mounting options—one midship, the other stern hung. With the Hobie eVolve, you can either maintain steady cruising speeds of two knots (motor only) for hours, or you can open the throttle for short sprints. Best yet, depending on your set-up, you can use the eVolve to augment your boat speed while also using your MirageDrive. And thanks to its cockpit-mounted Remote Throttle, you always know how much juice you have left in the system's 320 Wh Lithium-Manganese battery. Runtime estimated as 8 hr 20 min at 2.6 mph / 48 min full throttle.

If you thought the MirageDrive made kayaking sweeter, wait until you try the eVolve v2 system. The eVolve v2 offers increased battery capacity, longer range and solar charge / run capability (solar panel accessory not yet available). Life only improves with power.

72022030 EVOLVE v2 TORQEEDO MOTOR KIT - Kayak
72022040 EVOLVE v2 TORQEEDO MOTOR KIT - i Series

EVOLVE v2 KIT INCLUDES:

- Ready-to-go Mirage well-mounted Hobie eVolve v2
- All cables for the motor and throttle units
- All mounting hardware
- Assembly that integrates the motor with a Twist and Stow rudder
- Sealed/Waterproof Lithium-Manganese high-performance battery 320 Wh (charger included)
- Remote throttle system displays speed and distance information generated by an onboard GPS unit
- Magnetic safety key
- Waterproof fittings and cable connectors
- Solar charging port (Solar panel accessory not yet available)
- Corrosion-resistant materials ensure durability and performance
- Lightweight power: Total weight of installed kit is 18 lbs (8.16 kg) or less, depending on the configuration



2 for 1

BOTH MOUNTS INCLUDED

For all Mirage Series except no Rudder Mount for Inflatables, Island Series, and Pro Angler



RUDDER POSITION MOUNT

The rudder-mounted eVolve is the ultimate tool for extending your range and exploration options. This slick system uses a lightweight aluminum assembly to easily integrate an eVolve motor with a Twist and Stow rudder. Pedal and motor; motor, or simply pedal. When off, the engine becomes your rudder or it can be brought on deck via the Twist and Stow controls. (Rudder Mount not included in kit for Pro Angler and Inflatables.)



MIRAGE WELL MOUNT

A clever option for mounting the eVolve motor package is to swap out your MirageDrive for this electric unit. Just slot the well-mounted Hobie eVolve into any MirageDrive kayak and instantly enjoy powered propulsion. Ready to use fresh out of the box, the Mirage-mounted eVolve weighs a scant 6.4 pounds—that's 0.2 pounds less than the MirageDrive—and is built to take years of exploration and adventure.



REMOTE THROTTLE

While the outboard might be transom-hung, the driver doesn't have to sit astern thanks to our Remote Throttle, which attaches via a RAM mounting unit (included) to provide throttle control from your favorite seating position. The LCD screen displays all the trip info you need (such as speed and range) while you're underway. For safety, the unit features a magnetic key-to-throttle connection; break this magnetic connection and the motor immediately stops.



LITHIUM BATTERY V2

A lightweight, 6.6-pound, 320 Wh Lithium-Manganese battery (11Ah at 29.6V) powers the system's featherweight Torqeedo motor. The battery is buoyant and completely waterproof, ensuring safety and there-when-you-need-it performance. Its built-in GPS unit generates pertinent information such as speed and range. Solar charge / run port.

ST PERFORMANCE FINS ST or ST TURBO!

ST FINS ...and you thought the Hobie MirageDrive was the most amazing propulsion system ever seen! Now you can make your Hobie MirageDrive a **SUPER PERFORMER!**

Hobie Mirage kayak users report as much as 10% increase in speed and more using ST TURBO Fins. But its not all about speed, you can get top end speed and a slower cadence for cruising (Less pedals per mile). All achieved with these larger and more efficient fin designs. Increase your performance or increase your fitness routine, you choose the fin that is right for you: Standard, ST or ST Turbo... low, medium or a higher gear! The standard fins, supplied with our kayaks, are the easiest pedaling fins, but many users feel that the standard fins do not offer enough resistance. This is very evident when using our sailing kits. The added power and speed of the sail often outpaces the standard fins (similar to pedaling a bike down hill in first gear). Want to go really fast? Add the ST TURBOs for sailing! The longer fins can also increase lateral resistance for sailing upwind.

These ST (Square Tip) designs will require a bit more effort to pedal. The added effort is commonly compared to pedaling a bike up a slight incline. In addition, the included fin tension screw allows adjustment to achieve lower end torque or top end speed to meet the desires of the pedaler.

ST Fins fit any Hobie MirageDrive. If you prefer the ST fin, order 2 per drive. The ST TURBO fins require longer masts. The ST TURBO fin kit comes with 2 fins, 2 masts and all needed fittings.

72066001 ST TURBO Fin Kit "V2" (2009 and Newer Threaded Sprocket)

72065 ST TURBO Fin Kit (Older SS or Set-screw Sprocket)

80013001 MirageDrive with ST Turbo fins

81193001 ST Fin / Single (Requires 2 per MirageDrive)

81192001 ST TURBO Fin / Single (replacement)



ST FIN

ST TURBO
FIN KIT

72065 ST TURBO KIT SHOWN



SIDEKICK AMA KIT

Whether you are a pro or a novice, you will enjoy the sense of security from the extra amount of stability offered by the SideKick ama kit. Great for use when sailing, fishing, standing when site fishing, shooting photos! The SideKick ama kit is simple, light weight and effective! The SideKick's cross arms adjust the float height with a simple "click-twist-click". Just like a paddle shaft adjustment. Three positions offer you high - medium - low positions. Set the floats high for cruising (less drag) or secondary stability. Use the medium or low settings for primary stability (less initial roll). Fine adjustments for float height are done by twisting the main crossbar within its mounts and tensioning with the fastening hardware. Set up and use right off the beach or disassemble and deflate to store inside the hull. Then assemble and inflate when you get to your dive or fishing spot. Inflation is simple. Just blow a few breaths into each float through their one-way valves. Valve cap unscrews for rapid deflation. Installs with 4 bolts using expanding nuts.

72062101 SIDEKICK AMA KIT - Light Gray

72063101 SIDEKICK AMA KIT - Dark Green

72062061 SIDEKICK +07 ADVENTURE MOUNTING ADAP PLATE SET

72062062 SIDEKICK - MOUNT KIT W/CENTER BAR



SIDEKICK AMA KIT Extra stability for your kayak. Fits all Hobie models and most other kayaks. Whether you sail, fish, shoot pictures, dive or just want to feel a bit more stable when using your kayak, the SIDEKICK AMA KIT will do it. Light weight and simple to install. The floats are inflatable.

OFFICIAL SUNGLASS SPONSOR



US SAILING



ABA



USLA



POLARIZED

WORLD'S BEST POLARIZED SUNGLASS



HOBIE ESCONDIDO
SHINY BLACK / GREY LENS

The Motion Series was designed for demanding sports enthusiasts who are unwilling to compromise on either function or style, featuring HydroClean™ lens technology. Our advanced hydrophobic coatings are applied under the most controlled conditions resulting in a lens that sheds water, resists dust and grime and is easy to clean.

WWW.HOBIEPOLARIZED.COM

HOBIE BIMINI SUN SHADE

We all love the sun, but it can be a bit much at times. Protect yourself with a Hobie Bimini Sun Shade. The Bimini is easily attached to most Hobie Kayaks. With the Hobie mount installed, a simple flick of a finger can attach, adjust or remove the Bimini. It can be easily folded out of the way or set up to block the sun. Simple adjustments can tilt the shade from side to side or to different heights and angles for best protection from the sun's rays. Requires Hobie mount. The Hobie Mount will attach to just about any kayak. It extends or retracts for a perfect fit.

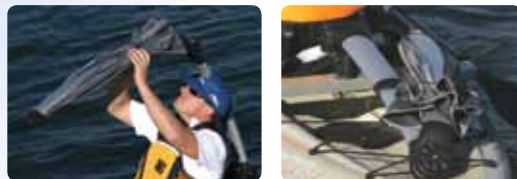

HOBIE BIMINI SUN SHADE (*Requires mount)

72700 Bimini Charcoal*

72701 Bimini Blue*

72702 Bimini Green*

72710 Hobie Mount



72710 Mount fits all Hobie models and most other kayaks (3 piece expandable). Attaches with included (4) bolts and expanding nuts.

HOBIE DODGER

The Hobie Dodger is a spray, cool breeze or sun shade for your lower body. Deflect bow spray, block cool breezes and stay warmer in cold conditions.

Works like a small pop-up tent. Loops of bungee connect to the boat via small fittings installed along the rails. Small internal battens give the Dodger its shape. The Dodger extends aft to just in front of the pedaler. A Velcro strip seals up the center in front of the pedaler. The entire dodger folds forward to enter or exit the kayak, to make pedal adjustments or reach items in the cockpit. An access panel is built-in for using the sailing rig. A great combination when there is wind and spray!

Great for hunters, animal and bird watchers as the Dodger conceals your legs movement. The Hobie Dodger makes your kayak a sit-inside sit-on-top!

Installs in minutes initially, but installs in moments once the fasteners are in place. Packs away into a small stow bag 5" round by 24" long (1.8 lbs).

Mirage Dodger Fits the Hobie Mirage Outback, Sport, Adventure and Revolution kayaks (May fit other models with some modification to hardware placement).

HOBIE MIRAGE DODGER

72720 Dodger Camo

72721 Dodger Silver

72722 Dodger Yellow

HOBIE ISLAND DODGER

72730001 Island Dodger Yellow

72730002 Island Dodger Silver

Tandem Island: Island Dodger forward / Mirage Dodger aft

HOBIE PRO ANGLER DODGER

72730003 Pro Angler Dodger Camo



SAIL RIG MAST ACCESS



Serious Fun



Hobie is thrilled to introduce an exciting new member of our fleet.

The **Hobie Mirage Tandem Island** is the big brother of our Hobie Mirage Adventure Island and twice the fun. Plenty of room for the skipper and crew, with total control of the roller furling sail and the large Twist and Stow rudder from either high back padded seat. Inspired by Polynesian multihulls, this 18' 6" trimaran "sail-yak" includes state-of-the-art features and comfort, plus two patented MirageDrives with Turbo Fins. So choose a partner and enjoy the ride.



POWERED BY



HOBIE
MirageDrive®



hobiecat.com

SAIL KITS

ADD SAILING TO YOUR HOBIE MIRAGE KAYAK EXPERIENCE!

MIRAGE KAYAK SAIL RIG

Add sail power to Hobie Mirage Kayaks! (Fits all current models of Hobie Mirage Kayaks). The Patented MirageDrive pedal system allows you to pedal while sailing which helps you to maintain forward motion through turns and obtain higher speeds. Sail with ease maintaining excellent speed with or without pedaling while sailing. Easily pedal out to sail or pedal home when the wind is too light. Add a SideKick ama kit for additional stability if desired.

HOBIE MIRAGE KAYAKS...

THE ONLY KAYAKS THAT CAN DO IT ALL

Paddle kayaks do not have the necessary lateral resistance needed nor do they typically have a rudder for steering. Paddle kayaks require hands-on paddling which prohibits use of rudder and sail controls for sailing. The MirageDrive pedal system allows you to pedal out onto the water to sail and pedal back if needed. You can also pedal the boat through a tack (turn). The MirageDrive pedal system's fins act as a keel or centerboard when in the down position offering the lateral resistance needed for upwind sailing. Hobie Mirage kayaks are equipped with a hand-controlled rudder. The MirageDrive allows hands to be free for sail and rudder controls. Two piece mast, sail, hardware, lines and durable storage bag included. Add the large rudder #81397001 for more responsive rudder control. Adventure models can add the dagger board for enhanced upwind performance.

SAIL KIT includes two piece mast, sail (20.25 sq ft.), lines, fittings and storage bag.



i-Series 79052203
84515001

i-Series 79052204
84516001

84514001

i-Series 79052202
84513001

- 84513001** Sail Kit (Turq/Papaya)
- 84514001** Sail Kit (White/Red)
- 84515001** Sail Kit (White/Turq)
- 84516001** Sail Kit (Silver/White)

- 79052202** i-Series Sail Kit (Turq/Papaya)
- 79052203** i-Series Sail Kit (White/Turq)
- 79052204** i-Series Sail Kit (Silver/White)

- 81397001** "Sailing" Rudder Blade (Lg TnS)
- 81397101** "Sailing" Rudder Blade i-Series
- 79502001** Adventure Sailing Daggerboard
- 84503** Replacement 2-piece mast
- 79052251** Replace 4-piece (i-Series) mast
- 84511** Replacement Sail Batten
- 84509001** Replacement Batten Cap
- RH112WHT** Batten Tie Line (per foot)

Adventure Daggerboard



Large Twist-n-Stow
"Sailing" Rudders

81397001

81397101



Sailing with Dodger



Sailing with
SideKick Ama Kit



For top sailing performance, add the ST TURBO
fin kit and larger rudder!



ADVENTURE ISLAND CONVERSIONS

The Hobie Mirage Adventure (2007 model and newer only) can be converted into an Adventure Island! These kits allow you to add just the amas or go all the way to Adventure Island with the amas and sail combined. Great sailing performance and excellent stability.

The complete kit includes: A boomless, roller-furling sail rig with plenty of sail area for excellent performance, completely manageable from the cockpit with the pull of a line. Two retractable amas that fold up against the side of the boat for easy docking, maneuverability, and transport. All 2007 and newer model year Adventure Kayaks, including the Fish model, have inserts molded into the hull. The Adventure Island kit is loaded with additional standard features such as a daggerboard; large "Twist and Stow" rudder; Mast and Sail Cover; and an Aka/Daggerboard Bag.

Conversions kits are available in V1 crossbar configuration only.

99503001 ISLAND CONVERSION KIT - PAPAYA

99504001 ISLAND CONVERSION KIT-HIBISCUS

99505001 ISLAND CONVERSION KIT - DUNE

99600001 INSTALL TOOLS - MAST HOLE SAW

(See part guide pages for replacement sails and parts)

Prices DO NOT include freight to dealer or assembly.

SAILING TIP!

SAIL POWER Watch the sail in order to pay close attention to the trim or adjustment of the sail. When the front of the sail, just behind the mast, luffs or flutters in the breeze, you lose power. To start moving, pull the sail in just enough to stop the sail from luffing or turn the boat away from the direction the wind is coming from. There are also short ribbons hanging on either side of the sail called "tell tails". The tell tails react to air flowing over the sail and will help you see that the sail is pulled in too tight or too loosely. If you pull the sail too tight you will stall the sail power. The tell tail on the back side of the sail will drop or do circles. Ease the sail out until it luffs, then pull it in just a little until it stops luffing. You will adjust the trim whenever the wind changes direction or you change course. See more on "Learn to sail the Hobie way" on our website in our "Support" area at:

<http://www.hobie kayaks.com/experience/learn.html>



AKA TRAMPOLINES FOR THE HOBIE MIRAGE ADVENTURE ISLAND AND TANDEM ISLAND

Aka Trampolines do many things... Added space for carrying gear, allows you to move weight outboard for better performance in windy conditions, comfortable sitting or laying down position, carry additional crew / kids / pets (does not increase basic weight capacity), reduce spray in cockpit. The trampolines are made from mesh vinyl as used on our catamaran product. Available in Grey or Black. Easy installation. Fast (side-release) buckles across aft aka make folding akas quick. Adjustable webbing straps for a tight fit. Rolls down and straps to forward aka for storage or easily slips off the aka. Paddle storage, gear pockets and lanyard grommets included. (200 Lb Capacity)

79527001 TRAMP SET AI - BLACK

79527011 TRAMP SET AI - GREY

88527001 TRAMP SET TI - BLACK

88527011 TRAMP SET TI - GREY

REPLACEMENT PARTS

79527101 LACING ROD

79527201 WEB/BUCKLE ASSY

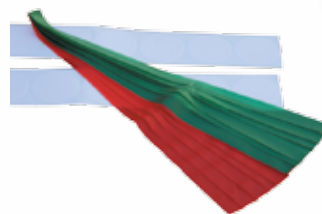

AIR-FLOW TELS

Trim your sails for optimum performance. Attached air flow over sails is critical. Air flow directions are indicated by these tell tails. Made of light weight rip stop nylon (Red / Green). Attaches to sails with waterproof adhesive disks.

334 Set of 14

HOBIE FISHING ACCESSORY PACKAGES



72020021 Ultimate Kayak Fishing Package

- 1 72020020 Fish Finder Package
- 1 71706001 Hobie Tackle Box 3 Pack
- 1 72023000 Rod Holder - RAM Tube
- 1 72020008 Anchor Trolley Kit
- 2 72020014 Hobie Rod Holder Extensions
- 2 74052001 Hobie Rod Leashes



72020033 ULTIMATE KAYAK NAVIGATION PACKAGE - COLOR GPS

- 1 72020018 Lowrance Color GPS
- 1 72023018 GPS Mount - RAM Mount
- 1 72020004 Richie Compass



72020024 MIRAGE Performance Package

- 1 72066001 V2 ST Turbo Fin Kit
- 1 81397001 Large Twist-n-Stow Rudder
- 1 80030001 Speedo Tube



72020020 FishFinder Package

- 1 72020005 Fish Finder - Lowrance X-4 PRO
- 1 72023007 FishFinder Mount - RAM Mount
- 1 72020011 FishFinder Installation Kit



72020022 Kayak Fly Fishing Package

- 1 72023008 Fly Rod Holder - RAM
- 1 72063101 Sidekick Ama Kit (Dark Green)
- 2 72020001 Hobie Gear Keeper



72020023 Kayak CUSTOMIZATION Package

- 1 71115101 Screw In Fittings Tool
- 5 71117001 Cleat
- 5 71116001 Padeye

HOBIE STAKE-OUT POLE

Hold position in shallow water by inserting the Hobie Stake-Out Pole into sand or mud. Fiberglass pole with metal tip, rubber grip handle and attachment line system. (Connect to the Hobie Anchor Trolley System for best results)

72076001 STAKE-OUT POLE

HOBIE ROD HOLDER EXTENSIONS

Keep your fishing rods secure and reels higher out of the water. These fit right into the molded-in rod holders and offer a larger diameter sleeve that is deeper. Leash the holder extension to the boat and the rod to the holder using the molded eyes.

72020014 ROD HOLDER EXTENSION

RAM MOUNTS AND LOWRANCE ELECTRONICS

See mount and electronics pages for details.

ANCHOR KIT

3 pound folding anchor, bag and 60 feet of line. (Connect to the Hobie Anchor Trolley System for best results)

80035A ANCHOR

HOBIE DRIFT CHUTE

Large cone shaped "para" chute deployed in the water slows your drift in windy conditions when anchoring is not possible or desired. Design keeps chute just under the surface and fully inflated. Anchor line not included. (Connect to the Hobie Anchor Trolley System for best results)

72020009 DRIFT CHUTE





72020025 KAYAK TRAVEL PACKAGE

- 1 72046 Roof Rack Pads - 36"
- 1 72042 Tie Down Straps
- 1 80045001 Kayak Cart "Plug-IN" Standard



72020026 KAYAK SAFETY PACKAGE

- 1 72020010 Hobie Safety Kit
- 1 72020002 Safety Flag
- 1 72020003 Hydrostar Light



72020029 DELUXE KAYAK SAFETY PACKAGE

- 1 72020010 Hobie Safety Kit
- 1 72020040 Visicarbon Safety Flag
- 1 72020032 Bilge Pump

HOBIE LIVEWELL

This live bait tank was designed with the serious fisherman in mind. From the tournament angler to the weekend warrior, inshore or off, this livewell is capable of handling almost every fishing situation imaginable! **See Livewell on page 18 for more details.**

72020007 Hobie Livewell

72020015 Rod Holder - Livewell
(Rod holders include needed fasteners)



HOBIE ANCHOR TROLLEY KIT

Easily deploy your anchor, drift chute or stake out pole over the side of the cockpit area, then move the attachment position forward or aft to hold your boat in the position desired. Easily sit facing down stream / wind at anchor. Simple pulley system and cleat allows adjustment all along one side of your boat anywhere from bow to stern.

72020008 ANCHOR TROLLEY KIT

HOBIE GEAR KEEPER

Keep your equipment where you left it; safe and onboard with the Hobie Gear Keepers. These low force retractor tools are ideal for gear such as pliers, dykes, lipper tools etc.

72020000 SMALL HOBIE GEAR KEEPER 2.5oz

Features: 36" 50lbs Breaking Strength Spectra Nylon Line, Plastic Snap Clip, 3/8" Quick Connect Split Ring.

72020001 LARGE HOBIE GEAR KEEPER

Features: 36" 60 lbs. Breaking Strength Nylon Coated Stainless Steel Cable, Stainless Steel Spring and Hardware, Plastic Snap Clip.



72020000

72020001



FISH GRIP

Handy fish grip in a glow-in-the-dark plastic material.

72020019 FISH GRIP



HOBIE ROD LEASH

Keep those nice fishing rods from swimming away. Secure the rod leash to boat and rod. Quick snap connection feature allows easy detachment when needed. Webbing construction with quick connect hook.

74052001 ROD LEASH - WEBBING

SAFETY FLAG

The 4' tall safety flag will help other boaters see you.

72020002 SAFETY FLAG 4'

72020012 DELUXE MOUNT

THE VISICARBON PRO™ combines a high visibility light and safety flag with a light weight, low drag, and portable style. Insert foam base into molded-in (or Live Well) rod holders or a Scotty mount.

72020040 SAFETY FLAG/LIGHT COMBO



HOBIE LIVEWELL

HOBIE LIVEWELL

Live up your day on the water with the Hobie Livewell! This live bait tank was designed with the serious fisherman in mind. From the tournament angler to the weekend warrior, inshore or off, this livewell is capable of handling almost every fishing situation imaginable! Water intake and discharge fit right into the existing scuppers in the cargo area. With a high-flow self-priming* Attwood pump, a 6 volt sealed gel cell battery, adjustable drain, and the capability of holding up to 8 gallons of water this tank can handle almost any creature that you can squeeze into it. Ready right out of the box! Just charge and go! (*requires forward motion in the kayak to prime pump)

72020007 Hobie Livewell Bait Tank

72020015 Rod Holder - Livewell

(Additional rod holders include the required fasteners)
(Livewell replacement parts shown on page 35)

Looking for somewhere to put those extra rods? No problem! Hobie has included three rod holders to make this livewell one of the most functional pieces of fishing equipment that you'll ever own. Three's not enough, you say? Well for those who are ready for anything, Hobie has left you enough room to attach two more! This is a must-have for every Hobie Angler.

FEATURES: Pump, On-off switch, 6 Volt sealed Gel Battery, Charger, Battery compartment with lid, Carry handle, Adjustable hold down straps, Twist-n-Seal access lid, Fully assembled / charge and go!
Custom designed to fit the current Hobie Mirage Outback, Sport, Adventure, Revolution, Pro Angler (needs 7" down tube), Quest, Tandem Island, Oasis and Odyssey.





HOBIE GEAR BUCKET

Add a drop-in "tackle box" to your 8" Hobie Twist-n-Seal hatch. These containers are 2 1/2" deep and hang on the hatch lip or can be slipped down into the hull so you can carry several. Keep one on the hatch lip for easy access. Closing the hatch presses the containers seal closed to ensure items stay in place. You can carry fishing tackle, spare parts, snacks, tools, sun screen, first aid supplies and more in these easily size-adjustable storage segments. Get the three pack with handy storage bag and pre-pack your fishing tackle for fishing different species. Be prepared when the fish start biting with easy access inside the hatch just in front of your seat.



- 71704001** 8" Hobie Gear Bucket
- 71706001** 3 Pack with Bag (8" Hobie Gear Bucket)
- 71705001** Bag for 3 Hobie Gear Buckets



HOBIE TWIST-N-SEAL HATCHES

TWIST-N-SEAL HATCHES have a better seal. The lids also hinge open, so you never lose the lid. Designed with a cork-screw-like mechanism for closure, a simple twist of the handle opens or closes the hatch. As the screw pulls down the hatch, you get a tight seal on the "O Ring" seal against the inner cylinder. The hatch seals around the edge of the cylinder and does not have to be held down against a flat surface to seal. This allows the hatch to seal even if the lid is partially open or tipped. Flip the handle into the recess to "lock" it closed. Available in 6" and 8" diameters. These hatches are now standard equipment on all Hobie Kayaks.

*Retrofit kits include gaskets (and 2 ea #8031130 screws for the 8").

- 71701011** 6" Twist-n-Seal Hatch
- 71701001** 6" Twist-n-Seal Retrofit Kit*
- 71701021** 6" Twist-n-Seal O Ring
- 71321001** 6" Mount Gasket
- 71702011** 8" Twist-n-Seal Hatch
- 71702001** 8" Twist-n-Seal Retrofit Kit*
- 71702021** 8" Twist-n-Seal O Ring
- 71331001** 8" Mount Gasket



HOBIE 6" HATCH BAG

Add a drop-in bag to the 6" Hobie Twist-n-seal hatch. Kit includes required back-up ring with lip, screws and bag with drawstring. (Available for 6" hatch only)

- 5421** 6" Hobie Bag Kit



HOBIE DRY BAG

8" diameter x 14". This dry bag is built of tough materials. Seals tight to keep your stuff dry.

- 71703001** 8" Hobie Dry Bag



SEE BAG

Transparent 13 oz. vinyl bags make quick work of locating things. Great for organizing gear and personal stuff. Keep your food and spare clothes dry. Easy to carry or tie onboard. Its cylindrical shape will hold odd shapes such as cameras, binoculars, lunches, etc. without distortion of bag and resultant potential leakage.

- 72210T** SEE BAG (8" x 14" 622 cu.in.)
- 72230T** SEE BAG (11" x 19" 2200 cu.in.)



PLANO® TACKLE BOX

Innovative up-latching fasteners and Dri-Loc® Seal ensure watertight storage.

TACKLE BOX SMALL 10 adjustable dividers create 5-15 compartments. Yellow/Clear 9.13" x 5" x 1.25"

- 72020311** TACKLE BOX SMALL

15 adjustable dividers create 5-20 compartments. Clear/Blue 11" x 7.25" x 1.75"

- 72020321** TACKLE BOX MEDIUM

25 dividers create 3-28 compartments. Perfect box for extra long bulk storage. Clear/Red 14" x 9.13" x 2"

- 72020331** TACKLE BOX LARGE

HOBIE ROD HOLDERS

HOW YOU STORE YOUR GEAR IS TOTALLY UP TO YOU... VERTICAL USING THE MOLDED-IN ROD HOLDERS... EXTENDED HIGHER USING HOBIE ROD HOLDER EXTENSIONS TO KEEP YOUR REELS DRYER OR NOW... HORIZONTAL AND SECURE IN OUR NEW HOBIE HORIZONTAL ROD HOLDERS! INSTALL ON ANY KAYAK. TIP PROTECTOR AND SECURE CLASP AROUND ROD HANDLE.

ROD HOLDER / BUCKET

HOBIE HATCH LINERS

FOR HOBIE MIRAGE OUTBACK AND REVOLUTION. CREATED AS PART OF THE POPULAR PRO ANGLER, THE FORWARD HATCH BUCKET IS A SPACE TO STORE GEAR OR FISH JUST INSIDE THE HATCH LID. KEEPS ITEMS FROM SLIDING FORWARD OR BACK INSIDE THE HULL AND KEEPS THEM UP OFF THE BILGE. NOW AVAILABLE FOR THE HOBIE OUTBACK AND HOBIE REVOLUTION.



REVOLUTION



OUTBACK

HOBIE HATCH LINERS

72020041 HATCH LINER FWD - OUTBACK

72020042 HATCH LINER FWD - REVO

HOBIE HORIZONTAL ROD HOLDER KIT Keep your fishing rod secure and protected along the side of your kayak. Insert the rod tip into the tip protector and lock the rod handle into the clasp. Easy to install using the provided hardware. Choose either through-bolts or sheet metal screws. Fits any kayak. Patent Pending.

72021060 HORIZONTAL ROD HOLDER KIT



HOBIE MOLDED-IN ROD HOLDER EXTENSIONS Keep your fishing rods secure and reels higher out of the water. These fit right into the molded-in rod holders and offer a larger diameter sleeve that is deeper. Leash the holder extension to the boat and the rod to the holder using the molded eyes.

72020014 ROD HOLDER EXTENSION



ROD HOLDER



RAM ROD HOLDERS / MOUNTS

is the revolutionary universal ball and socket mounting system that allows you to mount practically anything anywhere. Unlike other mounts on the market, RAM allows you to mount items where you need them most. If you need to mount a Rod Holder, GPS or FishFinder look no further. RAM mounts will help you make a professional job easy. Its unique design provides easy installation, mobility, strength, versatility, vibration protection and durability, all at a low cost. RAM is backed by a Lifetime Warranty which makes it the mounting system of choice. To provide light weight strength and corrosion resistance, RAM uses marine grade aluminum with a powder coated finish, light weight nylon injected molded plastic, stainless steel hardware and rubber balls.



- 72023000** RAM TUBE ROD HOLDER W/ BASE (1.5")
- 72023010** RAM TUBE ONLY (1.5")
- 72023001** RAM SMALL DIAMOND BASE (1")
- 72023002** RAM SPACE SAVER BASE (1.5")
- 72023003** RAM TUBE BASE 2 X 2.5 (1.5")
- 72023004** RAM POST CONV. ATTWOOD,SCOTTY (1.5")
- 72023008** RAM FLY ROD HOLDER W/BASE (1.5")
- 72023013** RAM (PLASTIC) PIVOT ROD HOLDER (1.5")
- 72023022** RAM PIVOT ROD HOLDER W/FLUSH MNT
- 72023014** RAM TUBE (PLASTIC) ROD HOLDER (1.5")
- 72023015** RAM ACCESS-TUBE WEDGE MOUNT (1.5")
- 72023016** RAM ACCESS-TUBE WEDGE MOUNT (1")
- 72023017** RAM U-BOLT RAIL BASE w/BALL (1")



72023001 RAM
SMALL DIAMOND (1")

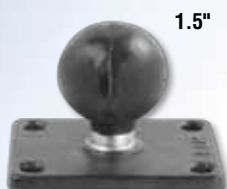

72023003 RAM 2 X 2.5 (1.5")



72023015 ACCESSORY
TUBE WEDGE MOUNT (1.5")



72023016 ACCESSORY
TUBE WEDGE MOUNT (1")



72023004
RAM POST SCOTTY CONVER-
SION (1.5")



72023017
U-BOLT RAIL BASE (1")



72023002
RAM SPACE SAVER (1.5")



72023013 RAM TUBE
(PLASTIC) PIVOT ROD HOLDER (1.5")



72023014 RAM TUBE
(PLASTIC) ROD HOLDER (1.5")



72023022 RAM TUBE (PLASTIC)
PIVOT ROD HOLDER W/ FLUSH MNT



72023000 RAM TUBE
(ALUMINUM) ROD HOLDER
W/ 72023003 BASE (1.5")



72023008 RAM FLY ROD HOLDER (1.5")

SCOTTY ROD HOLDERS / MOUNTS

SCOTTY ROD HOLDERS

Bait Caster/Spinning Rod Holder. Holds a baitcaster reel in a cushioned cradle. A slot in the front of the holder allows for a spinning reel to be securely held in position. The rod holder design has a side mounted flange, which leaves the bottom open. This allows for the rod holder to accommodate trigger sticks. Pistol grip rod butts easily clear the sides of the rod holder for quick rod retrieval. Rods can be secured in holder with a soft latching strap which snaps over the top. Fully adjustable up and down and rotates 360 degrees. Requires either the combination deck or side mounting bracket or flush deck mount (bolting dimensions - 1 5/16" x 3 3/16").

- 80048001** Rod Holder - Bait Caster w/mount
- 80055001** Rod Holder - Fly Rod w/mount
- 80048004** Rod Holder With Side-Deck Mount
- 80048005** Rod Holder Rocket Launcher
- 80048006** Gear Head Mount
- 80048002** Rod Holder Height Extender 8.5"
- 80048003** Rod Holder Height Extender 6.5"
- 80052001** Mount - Deck / Side
- 80049001** Mount - Flush
- 71330001** Gasket - Scotty Mount



80048001 BAIT CASTER ROD HOLDER WITH DECK / SIDE MOUNT



80055001 FLY ROD HOLDER WITH DECK / SIDE MOUNT



80048005 ROD HOLDER ROCKET LAUNCHER



80048004 ROD HOLDER W/SIDE-DECK MOUNT



80049001 FLUSH MOUNT



80048006 GEAR HEAD MOUNT



80048003 ROD HOLDER HEIGHT EXTENDER 6.5"



80048002 ROD HOLDER HEIGHT EXTENDER 8.5"

ROD MOUNTS / HUNTING



79052000

I - ACCESSORY HOLDER KIT

Designed to allow the attachment of rod holders and other accessories to the Hobie Mirage inflatable kayaks. The accessory kit comes with 2 mount plates and attachment glue. 4 hole pattern fits Scotty mount and RAM / Scotty hole pattern products. Mount the 80052001 Scotty Deck/Side mount and Scotty rod holders or adapt for the RAM products by adding 72023004 RAM Ball Scotty adapter. (1/4-20 Screws sold separately, check length for desired accessory / #8030380 7/8" length for Scotty deck mount).

79052000 i - ACCESSORY HOLDER KIT

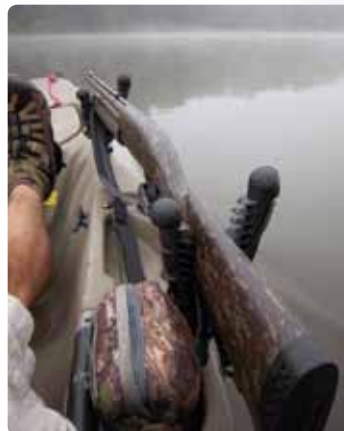

HUNTING



GUN MOUNT for your kayak. Mounts to kayak rail for easy access.
72020013 GUN MOUNT

LOWRANCE FISHFINDERS

COMPACT SERIES



Note: Lowrance Warranty is handled directly by Lowrance. Refer to documentation included with these products.



M68C S/MAP COMPACT FISHFINDER

- High-brightness 3.5" (8.9cm) diagonal 256-color, 1/4 VGA active matrix TFT transreflective LCD
 - Impressive 320V x 240H pixel resolution
 - 12-parallel channel GPS+WAAS receiver with internal antenna
 - 800 W peak-to-peak power
 - Depth penetration to 600 feet (183 m)
- Find fish and yourself in dazzling color, at a highly affordable price. Features high-detail hydrographic mapping and an internal GPS+WAAS receiver.

72020017 M68C

(Use Ram Mount 72023007 & Installation Kit 72020011)

X67C COMPACT FISHFINDER

- High-brightness 3.5" (8.9cm) diagonal 256-color, 1/4 VGA active matrix TFT transreflective LCD
 - Impressive 320H x 240W pixel resolution
 - 800 W peak-to-peak (100 W RMS) power
 - Low-profile high-performance 200 kHz Skimmer® - with built-in water surface temp sensor
 - Depth penetration to 600 feet (183 m)
- An exciting 256-color sonar performer with temp at a great low price. This unit packs a lot into a small package - 320x240 resolution, FishReveal™, HyperScroll™, ASP™, COLORLINE®, and more.

72020016 X67C

(Use Ram Mount 72023007 & Installation Kit 72020011)

X-4 PRO FISHFINDER

- Film SuperTwist LCD with 4-level gray scale
 - Compact Dual-Search 83/200 kHz Skimmer® with dual beams producing up to 120 degrees of wide fishfinding coverage
 - Depth penetration to 1000 feet (305 m)
- Featuring the Lowrance Dual-Search (DS) 83/200 kHz technology, this convenient, space-saving sonar unit comes with a high-contrast 240x160, 4" Film SuperTwist display with 4 levels of gray scale definition.

72020005 X-4 Pro

(Use Ram Mount 72023007 & Installation Kit 72020011)

FULL SIZE SERIES



ELITE-5 FISHFINDER/GPS CHARTPLOTTER

- True 12.7 cm/5 in., 480x480 pixel SolarMAX™ 256-color TFT display
- Dual-frequency 83/200 kHz fishfinding
- Internal 16-channel GPS antenna
- Built-in background mapping/charting
- Navionics® and other chart options available
- Depth penetration to 1000 feet (305 m); 500 W RMS, 4,000 W Peak-To-Peak

The newcolor Elite-5 fishfinder/chartplotter brings highperformance and high color to on-the-water enjoyment in every way, and without a highprice. Get incredible precision and functionality, in addition to a spectacular new view.

72020038 Elite-5 FishFinder / GPS Chartplotter

(Use Ram Mount 72023021 & Installation Kit 72020039)

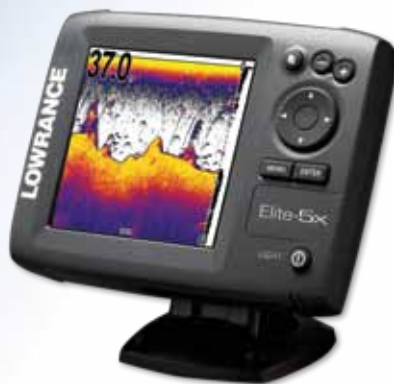

ELITE-5X FISHFINDER

- True 12.7 cm/5 in., 480x480 pixel SolarMAX™ 256-color TFT display
- Dual-frequency 83/200 kHz Skimmer® transom-mount transducer with internal temp sensor and up to 120° of wider sonar coverage
- Unique TrackBack™ feature for multi-page scroll-back review of fishfinder history
- Depth penetration to 1000 feet (305 m); 500 W RMS, 4,000 W Peak-To-Peak

The color Elite-5X Fishfinder brings a level of high performance and high color to serious anglers for an amazing low price. And it comes fully packed with legendary Lowrance features, incredible precision and functionality, in addition to a spectacular new view.

72020037 Elite-5X-Pro

(Use Ram Mount 72023021 & Installation Kit 72020039)



MARK-5X-PRO FISHFINDER

- High-resolution 5 in./12.7 cm, 480x480 pixel Film SuperTwist LCD
- Dual-frequency 83/200 kHz Skimmer® transom-mount transducer with internal temp sensor and up to 120° of wider sonar coverage
- Unique TrackBack™ feature offers immediate scroll-back to review multiple pages of echosounder history
- Depth penetration to 1000 feet (305 m); 300W RMS, 2,400W Peak-To-Peak

Powerful yet simplified performance, only Mark fishfinders offer legendary Lowrance features with a newly-optimized automatic mode for high-performance finding with turn-on-and-fish ease. Along with easy-to-use menus, there's also an Advanced User Mode for fine-tuning to water conditions.

72020036 Mark-5X-Pro

(Use Ram Mount 72023021 & Installation Kit 72020039)

MOUNT FISHFINDERS

RAM MOUNTS

We have chosen the best RAM mounts for use on the Hobie kayaks and our Lowrance Fishfinders.

COMPACT FISHFINDER MOUNT

72023007 FITS LOWRANCE X4-Pro, X67C, M68C; HUMMINBIRD PIRANHA MAX 10, 15, 20; EAGLE CUDA 240I, 240, 168, 128, FISH-EASY 320C, FISHEASY 240

FULL-SIZE FISHFINDER MOUNT

72023021 FITS LOWRANCE MARK, ELITE SERIES AND HUMMINBIRD 100, 300, 500, MATRIX SERIES



**72023007
FISHFINDER
COMPACT MOUNT**



**72023021
FISHFINDER
FULL-SIZE MOUNT**

INSTALL FISHFINDERS

COMPACT FISHFINDER INSTALLATION KIT

Hobie has taken the guess work out of installing a fishfinder by providing a simple yet complete installation kit. This kit is adaptable to virtually any kayak and will run most fishfinders on the market, like our Lowrance Compact Series fishfinders. The only thing you need to do is determine the location of your new unit! Kit includes: Dry Bag, Battery Harness, AA Batteries, Snap Connector, Foam Transducer Pad, Zip Ties, Marine Goop, Displacement Connectors, Rubber Grommet.

72020011 COMPACT FISHFINDER INSTALL KIT

72021011 SPARE TRANSDUCER PAD



FULL-SIZE FISHFINDER INSTALLATION KIT

Hobie's full size fishfinder installation kit integrates a waterproof 9AH gel cell 12-volt battery to provide more power to run larger units like the Lowrance Full Size Series of fishfinders. It can also be used to run smaller units for longer periods of time. Kit includes: Waterproof 9AH gel cell 12-volt battery with attached waterproof wiring and connectors, 12-volt battery charger, foam battery pad, foam transducer pad, zip ties, marine goop, wire connectors, rubber grommet, wire cap



72020039 FULL SIZE FISHFINDER INSTALL KIT

72021011 SPARE TRANSDUCER PAD

GPS - COLOR

ENDURA™ OUT&BACK Smartly designed for easy, out-of-the-box use, the Out&Back's straightforward menu makes navigation simple. Its large color transfective touch-screen allows for easy viewing and operation, and its pre-loaded mapping content with key land features such as lakes, rivers, primary roads and key Points of Interest (POI) provides accurate situational awareness. Out&Back is also easy to customize, including a recording option that saves trails and routes allowing quick recall or sharing, a geocaching application providing paperless geocaching with Geocaching.com and power standby to conserve battery life as well as provide quick restart. The Out&Back supports a wide range of optional mapping content. Like all Endura handhelds, the Out&Back accepts public domain files and community-based content such as GPX trails, routes and general outdoor POIs.

72020018 Endura Out&Back GPS
(Use Ram Mount 72023018)

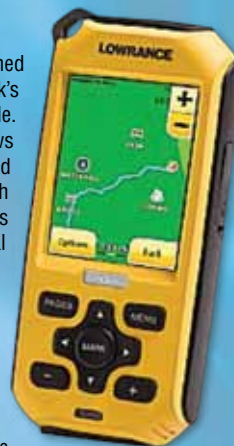

GPS MOUNT

72023018 RAM MOUNT LOWRANCE ENDURA



**72023018
ENDURA GPS MOUNT**



**72023006
UNIVERSAL MOUNT**

UNIVERSAL ELECTRONICS MOUNT

72023006 RAM UNIVERSAL MOUNT 6 1/4 X 2

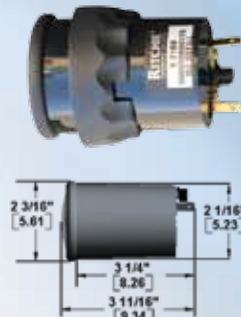

RITCHIE PANEL MOUNT COMPASS

When you're miles out to sea or simply trying to navigate your way through uncharted waterways, rest assured that you can make it back home with one of the worlds most innovative panel mounted compasses.

72020004 RITCHIE COMPASS PANEL MNT X-21

Features:

- 2" (5.08 cm) Direct Reading Dial
- Easily Installed, Fits Standard 2 1/16" (5.50 cm) Instrument Hole
- View Adjusts up to 30 degrees
- Scientifically Matched Sapphire Jewel & Hardened Steel Pivot Dial Movement
- Exclusive Built-in Green NiteVu Lighting
- High Temperature Composite Construction for Extended Operating Range
- DirectiveForce Magnets
- Exclusive 5-Year Ritchie Warranty

KAYAK CARTS



Kayak Carts are a must for easily transporting your kayak from car to water's edge. Simply roll the kayak down to the water and off you go! All of the latest Hobie Kayaks can use "Plug-in" carts. "Plug-in" carts do just that...they plug right into the bottom of your kayak. Choose Standard for light duty and solid surfaces, Heavy Duty for heavy loads and rough terrain or the "all-terrain" Hobie Trax "2" version which is the best over soft sand. Each cart has a sturdy stainless steel frame. Some older models or other brands of kayaks may require the use of a cart that straps on.

CART KEEPER FEATURE (fig. 1a)

Standard on Hobie Plug-in carts! After insertion of the cart, pull the dome pin out and re-insert as shown to keep the cart captive.

POST COLLAR / CLAMP FEATURE (fig. 1b)

Collar clamps help to reduce the direct loading of the cart on your kayak's bottom / keel. Direct loads on hull bottoms can cause deformation of the kayak. Even loading at scuppers and hull bottom reduces hull-bottom deformation issues.

CAUTIONS: Be certain that the cart inserts clear through the kayak and protrudes into the cockpit / cargo area surface. Kayaks should never be left on carts for prolonged periods of time.



KAYAK CART "PLUG-IN" STANDARD

Light weight with durable tires and strong spoked wheels. Stainless steel frame. Wheels are easily removable for storage. Also includes cart keeper feature and cart clamps. This cart has the medium capacity. (150 lb Capacity)

80045001 STANDARD CART

80045101 i - KAYAK CART

i - kayak cart (not pictured) plugs into an inflatable's MirageDrive well.

KAYAK CART - "PLUG-IN" HEAVY DUTY

Highest capacity cart with very durable knobby (Solid Foam) wheels. Welded Stainless steel frame. Wheels are easily removable for storage. Also includes cart keeper feature and cart clamps. This cart has the highest capacity. (225 lb Capacity) Recommended cart for Pro Angler and Tandem Island.

80046001 HEAVY DUTY CART

KAYAK CART "PLUG-IN" HOBIE TRAX "2"

The Trax "2" Cart has 24 cm (blow-molded polyurethane) pneumatic tires. These tires have a high capacity and are very durable! This is the best all around cart for soft sand and uneven terrain. The tires are wide and can be deflated for better performance over softer sand and soil. Welded Stainless steel frame. Wheels are easily removable for storage. (176 lb Capacity)

80044101 TRAX "2" CART



KAYAK CART - UNIVERSAL

This cart attaches to any kayak via straps and buckles. Pneumatic wheels allow this cart to roll more easily over rough terrain. Padded "hull-centering" bunks keep the kayak centered on the cart while the tie down straps hold the cart firmly to the boat. Carries loads up to 150 lbs. Welded Stainless steel construction. Wheels are easily removable.

80041 UNIVERSAL CART



MINI KAYAK CART

An easy way to pull your kayak around. Durable and lightweight, it simply straps on to the hull and off you go. Stores neatly in your hull's cargo bay while you're paddling. Best on smooth surfaces, not all-terrain.

72080 Mini Cart



POST COLLAR / CLAMP KIT

Collar clamps help to reduce the direct loading of the cart on your kayak's bottom / keel. Direct loads on hull bottoms can cause deformation of the kayak. Even loading at scuppers and hull bottom reduces hull-bottom deformation issues. Fits all year-models of Hobie plug-in carts.

80044201 COLLAR / CLAMP KIT



80043

HEAVY DUTY UPGRADES

Standard or Trax plug-in carts can be upgraded to heavy duty pneumatic wheels. May require removal of welded washer on some versions or bonding of the

sleeve to the axle using epoxy depending on cart vintage.

80043 Plug-in UPGRADE KIT

Newer Standard carts have a longer axle. 2 holes for keeper pins. One for standard wheels and the outermost for the HD wheels. Simply buy two new HD foam wheels and install.

80046041 HD Foam Wheel

KAYAK TRAILERS

These trailers are versatile platforms that can be used for any kayaks. Order the basic single or double trailer to carry one or more kayaks inverted on the crossbars (crossbar padding is not provided). For the Adventure Island, Tandem Island or Pro Angler, add the custom designed hull cradle sets. These are form fitted and foam covered. Strap down your Adventure Island with the custom tie down set. For two Adventure Islands, order the double trailer (Double-Double for two Tandem Islands) add two cradle sets and the center Tower System. The Tower includes mast / sail hangers and is also designed to mount an equipment box on top (Does not include box shown). Easily mount the Hobie Toy Box on top of the Tower (Thule box shown). Trailers ride on 8" wheels and use a 1 7/8" coupler.

(1 7/8")

38652200 DOUBLE

38652000 SINGLE

Trailers shown with Adventure Island Cradles 72020400



Trailer prices DO NOT include freight to dealer or assembly costs. Thule storage box shown is not included and not available through Hobie Cat.

38652000 TRAILEX TRAILER - SINGLE

Shown above with AI cradle set (#72020400)

38652200 TRAILEX TRAILER - DOUBLE

Shown above with 2 AI and cradles sets (#72020400) and (#38652210) tower system.

38652201 TRAILEX TRAILER - DOUBLE / DOUBLE

Not shown. Required to carry 2 Tandem Islands side by side (96" Crossbars).

72020400 AI CRADLES



72020402 TI CRADLES



72020401 PRO A CRADLES



72020400 CRADLE SET (1 boat) - ADVENTURE ISLAND

72020402 CRADLE SET (1 boat) - TANDEM ISLAND

72020401 CRADLE SET (1 boat) - PRO ANGLER

38653300 UNIVERSAL PAD SET - ALL OTHER KAYAKS

38652210 TOWER

Add the optional tower for equipment box mounting on a double trailer, multi kayak transport (Up to 4 kayaks leaned against tower). Also includes two mast carriers for 2x AI/TI configuration.

STORAGE BOX "TOY BOX"

Roto-molded seamless with molded-in graphics. Big enough to hold paddles, MirageDrives, Seat backs, Life Vests and wet wear and have room left for odds and ends. The bottom is ribbed to allow wet things to drain.

There is full access from front and back. Mounting hardware is not included. Length 10' 4", Width (rear) 21", Depth (rear) 13", Width (front) 19 1/2", Depth (front) 10", Weight 55 lb.

1825WHT One piece equipment box. Additional freight charges may apply.

Prices DO NOT include freight to dealer.



ROOF RACK PAD

Beefy car roof rack pads, made from durable black polyester with Hobie diamond logo. Easy-on split bottom with Velcro™ closure.

72045 24" Roof Rack Pad (Pair)

72046 36" Roof Rack Pad (Pair)



QUICK STRAP SPORTRACK

Easily installs on any vehicle with front and rear doors or opening windows. The straps secure inside the car, no gutter hooks are required. Packed in mesh storage bag (#72040 with bow and stern tie downs).

72040 Quick Strap SportRack (30" Pair)

72035 Quick Strap SportRack (24" Pair / NO LINES)



TIE DOWN STRAPS

Car roof rack tie-down straps, made of durable black polypropylene webbing.

72042 TIE DOWNS 12' (Pair)

72043 TIE DOWNS 15' (Pair)



HOBIE STEEL-CORE TIE DOWN STRAPS

Get a secure feeling when leaving your kayaks loaded, but in an unsecure area. Tie-down straps that incorporate cut resistant steel cable within for added security! Strap it down and LOCK it down... all-in-one function!

STEELCORE FEATURES

STEELCORE IS AN ALL IN ONE SECURITY DEVICE AND TIE-DOWN STRAP. PROTECTS YOUR GEAR FROM THEFT WHEN YOU TIE IT DOWN.

LOCK A WEATHER RESISTANT STAINLESS STEEL SCALPED CAM LOCK FROM ILLINOIS LOCK COMPANY

BUCKLE HARDENED AIRCRAFT ALUMINUM (6061) DESIGNED BY THE BEST AEROSPACE ENGINEERS

STRAP THICK POLYPROPYLENE WEBBING. WITH A CORE MADE FROM CUT RESISTANT STEEL AIRCRAFT CABLE

BUNGEE / CORD LOCK KEEPS IT FROM UNRAVELING WHEN ROLLED UP AND HOLDS THE EXTRA STRAP WHEN IN USE

72047 12' STL-COR STRAP (Pair)

72048 15' STL-COR STRAP (Pair)

COVERS



HOBIE TANDEM ISLAND SHOWN



KAYAK COVERS

Protect your kayak from the effects of the weather, UV rays, dirt, leaves and birds. We have chosen four sizes to fit the entire line of Hobie Kayaks. These covers are easy to install or remove, fits over the hull (like a fitted sheet on a mattress). Straps and pull string adjust for a tight fit. Cross straps secure the cover on your hull for windy conditions. Heavy duty UV resistant canvas material in a neutral color for better aging. These covers fit over the hull when upright or upside down. To help prevent distortions to the hull bottom shape, Hobie recommends that our kayak hulls be stored upside down resting on the cockpit rails. This is also best for deflecting rainwater and prevents water pooling in the cockpit or on the cover. When planning to store a hull upright, be sure to properly support the hull bottom to prevent hull distortions.

72050 Kayak Cover / 9'-12'
(LANAI, MAUI, SPORT, KONA-Tight)

72051 Kayak Cover / 12'-15'
(KONA [LOOSE], PURSUIT, MIRAGE CLASSIC, TANDEM / OASIS, OUTFITTER, QUEST, OUTBACK, REVOLUTION, PRO ANGLER)

72052 Kayak Cover / 14'-16'
(ADVENTURE, TANDEM/OASIS, ODYSSEY)

72053 Kayak Cover / 14'-16'6"
(*ADVENTURE ISLAND-FOLDED)

72054 Kayak Cover / 16'-18'6"
(*TANDEM ISLAND-FOLDED)



TALIC SEAHORSE RACK

Portable storage for kayaks under 100 lbs. Made of corrosion resistant anodized aluminum. Can be used indoors or out. Raises your kayak up to accessible height for outfitting accessories, cleaning or just keeping it off the garage floor. Collapsible for storage.

72088001 31" Talic SeaHorse Rack



MIRAGEDRIVE STOW BAG

Protect your MirageDrive... and other goods in your car from the drive! This heavy duty Cordura and mesh bag fits the complete MirageDrive with standard fins or the ST Turbo length. It has small pockets inside for the speedo tube, scupper plugs or spare parts. Has a carry handle and a shoulder carry strap. There is extra space in the bag for things like a life vest or drive well plug. Revised bag design is longer to better accommodate ST Turbo fins. Also includes "D" ring fittings to allow attachment to Inflatable's drive, pump and 4 piece paddle.

80024 MIRAGE DRIVE BAG



SHOCKCORD BALL TIES

Lashing equipment to your boat is quick and easy with this handy tie-down. Dozens of uses.

370 Each

HOBIE LUGGAGE

We now offer a selection of quality Hobie luggage. These three pieces represent the most popular luggage items. A back pack, rolling duffel and an expandable rolling suitcase are just the thing for the Hobie traveler! All bags are Army green.



72020500 HOBIE EXPANDABLE UPRIGHT
29" x 17" x 11"

72020501 HOBIE WHEELED DUFFEL
26" x 13" x 13"

72020502 HOBIE BACK PACK
21" x 14" x 9"



HOBIE WHEELED DUFFEL

- Wheeled heavy duty duffel bag
- U-shaped main opening for easy access
- Zipped compartments on both sides, one with mesh pocket
- Shoe compartment with easy to clean lining material
- Sturdy bottom structure and edge guard
- Detachable inside supporting straps to keep bag standing
- Padded shoulder strap

HOBIE EXPANDABLE UPRIGHT

- Main interior compartment includes top and side mesh pocket
- 3 zippered compartments in the front lid for easy access of small items and shoes
- Zippered packing compartment with straps inside lid provides better organization
- Smooth retractable handle and rolling wheels
- Padded top, side and two front handles make lifting easy
- TSA lock included
- Detachable toiletry bag included
- Integrated ID tag

HOBIE BACK PACK

- 4 zippered compartments for better organizing contents
- Padded laptop sleeve in main compartment
- Organizer for cell phone and office items in front compartment
- Zippered media pocket for mp3 player
- Ergonomic padded shoulder straps with hardware adjusts and cross strap to stabilize the pack
- Molded form back panel with air flow channels for carrying comfort
- Side zippered pocket and mesh pocket to hold small items and water bottle
- Attached rain cover inside bottom zippered pocket



GUSSETED STOW BAG

Our 6" by 12" gusseted tramp bag rises to the occasion. It has hooks on both ends to clip to your boat and carries the Hobie logo. Also available in 8" x 12" size. Securely stow tool, gloves or small parts for easy access on board your kayak.

72000B 6"x12" GUSSETED TRAMP BAG

72005B 8"x12" GUSSETED TRAMP BAG





DRIVE WELL SEAL

Keeps the seat area drier. Seals the aft end of the MirageDrive well. Limits the incursion of water into the cockpit caused by the surge action of the drive fins. Testers also claim some improvement of forward thrust. Easily attaches to any MirageDrive. Kit includes one seal and two attachment "zip ties".

81037001 Well Seal

81038001 i - Well Seal



MIRAGEDRIVE SPARE PARTS KITS

Spare parts kits include a fin, mast, sprocket, chain and appropriate parts for the drive version. Older drives have sprockets and masts that use a set screw connection. "V2" drives use threaded sprockets and masts. All in a handy zippered pouch. Don't waste a day on the water when your MirageDrive could be easily repaired. Available for the standard fin drive or a drive with the ST Turbo fins. Standard kit shown.

80010201 Standard (Set Screw Sprocket)

80013201 Turbo (Set Screw Sprocket)

"V2" Standard (Threaded Sprocket)

80013301 "V2" Turbo (Threaded Sprocket)



LEASH KIT - MIRAGEDRIVE

If you ever remove your MirageDrive while on the water... protect your investment from an accidental drop overboard. Includes hardware for attachment to the hull.

74052101 LEASH KIT - MIRAGE DRIVE



PADDLE "T" HANDLE

Convert your kayak paddle to a canoe style paddle. Easier to store on many models of Hobie Mirage kayaks where paddle use is unnecessary while using the MirageDrive. Plugs into the female half of the kayak paddle.

74049001 PADDLE "T" HANDLE



MIRAGE SEAT PAD - INFLATABLE "I-COMFORT"

Adjustable comfort! Replaces the standard foam seat pad for the Hobie Mirage. Adjust the cushion by adding or releasing air pressure. Like an inflatable camping pad. Has an internal self inflating foam and an air valve through which the pad can be further inflated / deflated to suit the users comfort. Not designed for use on Hobie Mirage Inflatable kayaks. Can be used in combination (stacked) on the standard seat cushion.

72020028 MIRAGE SEAT PAD - INFLATABLE "i-Comfort"



STEERING KNOB ASSY

Get a grip on your steering. More comfortable hand position - better leverage. Fits all 2011 Mirage model steering handles and all Tandem Islands.

88991355 KNOB ASSY



PEDAL PAD KIT

Softer on your feet! Neoprene pads are self adhesive and stick right to your pedals.

72020034 PEDAL PAD KIT BLACK (PAIR)



HOBIE MIRAGE SPEEDO

Removable, "pitot tube" speedometer measures your pedaling speed. Fits current MirageDrive systems only (Plastic spine on drive serial number 16054 and higher).

80030001 SPEEDO

KAYAK RIGGING KIT - HARDWARE

Set of fasteners for rigging a kayak for fishing accessories. A custom selection of hardware chosen by the Hobie fishing experts. Includes stainless bolts, nuts, washers, well nuts and more. All packed in a handy Plano box. You can purchase any of the items separately. Purchase the kit and have it all, or pick and choose your own based on your individual needs. All included parts are listed below as well as many more in the numerical section of our catalog.

72020300 Kayak rigging kit

Item	Qty	Part	Item
1	1	72020311	PLANO BOX - KAYAK RIG KIT
2	12	8031191	SCREW 1/4-20 X 1-1/4 PHMS
3	12	8030111	SCREW 10-32 X 1 PHMS-P SS
4	12	8030251	SCREW 10-32 X 1" FHMS
5	12	8030161	SCREW 10-32x1 1/2 RHMS-P SS
6	18	8080701	WASHER 1/4 X 1 SS HP
7	24	8080731	WASHER #10 FNDR SS
8	12	8050111	NUT 1/4-20 HX NYLOCK
9	24	8050201	NUT 10-32 NYLOCK LOPRO
10	12	8050221	NUT (WELL NUT) 10-32 x1
11	8	71110001	PAD EYE-BLK NYLON-3/8"
12	18	81029	LINE HANGER
13	8	78510001	BUNGEE HOOK

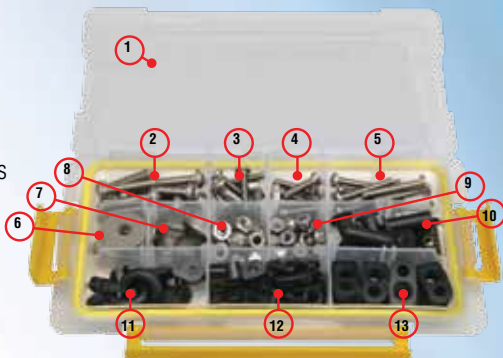

TECH TIP!

"WELL NUT" FASTENERS are tubular rubber fittings with an imbedded brass nut in the base. These are similar to a molly screw commonly used in sheet rock. They expand within the structure and give you a virtual backing nut and washer in an area that is inaccessible. Well nuts can be used for mounting many accessories to kayaks. Simply drill a hole as a net-fit dimension for the well nut. Insert the nut and position the hardware to be fastened. Insert and thread in the screw. Tighten until very snug. The brass nut is drawn up against the inside surface of the kayak which expands the rubber to a dimension that is too large to pull through the hole.



STAINLESS STEEL POCKET KNIVES

STANDARD - Marlin spike and single blade. 3.5 oz.

1550 Standard

DELUXE - Marlin spike, knife blade, shackle tool, and screwdriver. 4.0 oz.

1551 Deluxe

YACHTSMAN - Marlin spike, blade, shackle tool. 2.0 oz.

1555 Yachtsman

KC WELDER PRO WITH HOBBIE COLOR ROD STOCK

80 Watt element, flat tip and a 3/16" hole in tip for rod insertion. Includes a selection of Hobie color welding rod. Fix holes and cracks or customize polyethylene products. Insert the rod into the tip and place against the product to be welded. The tip heats the plastic surface and the rod. As the materials melt, move the tip along the repair area while pushing the rod into the tip to fill the repair area with new plastic material. Plug small holes after moving accessories. Rebuild keels after excessive wear from dragging.

72097001 KC WELDER PRO



GERBER NEEDLENOSE MULTI-PLIER®

Since 1939 Gerber has produced high quality innovative products for the outdoors. Features included in this model are; needlenose pliers, wire cutter, crimper, standard/ metric scale, lanyard ring, cross head screwdriver, bottle/can opener, serrated sheeps foot blade, large, medium, and small flathead screwdrivers, file, drop point blade, and it adapts to the Gerber Tool Kit! This Multi-Plier® comes with the S.A.F.T. PLUS™ System where each component opens independently of all others, locks tightly against a positive stop roll bar and stays tight until you unlock it. Stainless steel construction with a limited lifetime warranty!

83102 GERBER TOOL

PADDLE LEASH

Secure paddle to your boats bow eye. Keep the paddle with the boat after a capsize. By holding the paddle after a capsize you can also be sure that the boat stays with you and cannot drift away. Web paddle leash is made from hollow webbing and an internal shock cord. Coil leash is elastic plastic coil.

74050001 PADDLE LEASH - WEB 4.5'

74051001 PADDLE LEASH - COIL



MULTI STRAP SYSTEM

Hang your kayak for storage, use as bow and stern lines or use them as carrying handles. Multi purpose straps can be attached to the boat and adjusted for many uses. Made from durable black polypropylene webbing.

72041 MULTI STRAP (Pair)



THIGH CONTROL STRAPS

Padded thigh control straps. Clip to standard kayaks. Hook over thigh/knees for better control and power when paddling.

72500001 THIGH CONTROL STRAPS



HOG RING PLIERS

Cinch rings, hog rings, upholsterers clamp. They are all the same and these are the pliers to crimp them with. Use them on shockcord.

83104 Each

**BOW SHACKLE - THREADED PIN**

Part #	Pin Dia.	Width	Length	Max Ld#
SP150061	1/4"	9/16"	15/16"	4400

**"D" SHACKLES - THREADED PIN**

Part #	Pin Dia.	Width	Length	Max Ld#
SP150041	5/32"	3/8"	5/8"	1100
SP150051	3/16"	1/2"	11/16"	2640
SP150052	3/16"	5/8"	15/16"	2640
SP150053	3/16"	5/8"	1 7/16"	2640

**SAFETY SHACKLE WITH 1/2 TURN CAPTIVE PIN**

Part #	Pin Dia.	Width	Length	Max Ld#
SP185205	3/16"	1/2"	1"	2640
SP180005	3/16"	5/8"	1 7/16"	2640
SP180006	1/4"	7/8"	1 5/8"	4400

**TWIST SHACKLE WITH 1/2 TURN PIN**

Part #	Pin Dia.	Width	Length	Max Ld#
SP170005	3/16"	1/2"	7/8"	2640
SP170006	1/4"	9/16"	1 3/8"	4400

**FAST SHACKLE**

Avibank ball lock pin permanently wired to the shackle so it won't drop in the drink when released.

3062 Each

2101



2102

SHOCKCORD SNAP HOOKS

Easy to install shockcord snap hook. No tools required. Reusable!

2101 Hook-1/4"

2102 Hook-5/16"

**SUPER LOW STRETCH LINE**

Pre-stretched polyester line with superior fatigue and abrasion resistance. Our line (3/16"-3/8") tested as the lowest stretch (.5%) of any all polyester line available. Sold per foot.

RH112WHT 1/12" White

RH018WHT 1/8" White

RH316WHT 3/16" White

RH014WHT 1/4" White

RH516WHT 5/16" White

RH038WHT 3/8" White



WHT



BLU



RED



BLK

SPUN DACRON

Soft matte finish rope. Runs well thru blocks and fairleads, has good abrasion resistance, is spliceable and easy to hold with wet hands. Available in white, black, red, blue. This rope is not designed for winching. Sold per foot. Specify color choice.

(White, Blue, Red or Black xxx = color)

RM014WHT 1/4" White

RM014XXX 1/4" Color

RM516WHT 5/16" White

RM516XXX 5/16" Color

RM038WHT 3/8" White

RM038XXX 3/8" Color

RM716WHT 7/16" White

RM716XXX 7/16" Color

SPECTRA

Rudder Steering and Up / Down control line .
81023001 Spectra 1.75 MM

**HARKEN 16MM AIR BLOCKS**

Harken's newest small blocks for control lines. Accepts up to 7/32" line, 900 pound load, 5/8" sheave diameter. Ultra light weight.

H404 Single

H405 Single w/Becket

H406 Double

H407 Double w/Bcket

H082



H083



H092



H166



H167

**HARKEN BULLET BLOCKS**

Medium size blocks that work well for control lines. Accepts up to 5/16" line, 2000 pound load, 1 1/8" diameter sheave.

H082 Single

H083 Single /Becket

H092 Cheek

H166 Single w/Swivel

H167 Single w/Swivel & Becket



H224



H233



H225

HARKEN MICRO BLOCKS

Small blocks with high load capabilities, but light weight. Accepts up to 1/4" line, 1200 pound load, 7/8" diameter sheave.

H224 Single

H225 Single w/Becket

H233 Cheek

**REMOVABLE SHEAVE BLOCK**

Simply remove the clevis pin that acts as the sheave axle, slide the sheave out of the frame, place the frame through the fitting and reinstall the sheave.

3103 Each

**SUPER STRETCH SHOCKCORD**

This midnight-black shockcord has double the stretch of ordinary cord. If you've been getting your shockcord from the hardware store, you're in for a treat. The durable black cover is woven around an extra-flexible rubber core.

RS018BLK 1/8"

RS316BLK 3/16"

RS014BLK 1/4"

RS516BLK 5/16"

RS038BLK 3/8"

RS716BLK 7/16"

53180011 3/8" Hog ring

21180000 1/2" Hog ring



ONE WRAP VELCRO®

Cut this double faced Velcro® product to length and wrap it around items, line or whatever you need to secure. One side is hook and the other a loop, so a single piece is all you need.

7904 One Wrap, per foot

CLEATS



HARKEN CAMMATIC CLEAT

Rounded jaws assure quick cleating/release action and smoother teeth mean longer life for your lines.

H471 Micro Cleat, Carbo Jaw
1/8" to 1/4" line



HARKEN WEDGES

Fairleads and eyestraps designed specifically for each Cammatics, the wedges put the Cammatic on a 15 degree angle for ease of cleating or releasing. The fairleads are molded into a replacement base. The eyestraps are designed to be held in place over the cam by the mounting screws.

H297 Wedge Kit
H284 Wire Fairlead
H281 Eye Strap



CLEAR SILICONE SEALER

Make sure your hulls are watertight! Clear Silicone seals leaks around all thru-hull fittings.

376 1.5 oz. Tube



TWO PART EPOXY PUTTY

Simple to use putty-like repair epoxy. Quick and easy, it works fast to patch up small dings and scratches in fiberglass or plastic parts. Just mix, let dry, sand lightly and you are ready to go.

82300001 1 Pound



AQUASEAL MIRAZYME ODOR ELIMINATOR

There's nothing quite like the odor of damp gear left in your car trunk for a couple of days. With one application eliminate those odors from booties, wet-suits, dry-suits and the rest of your gear. A 100% biodegradable product made from a blend of 10 highly specialized, light activated microbial elements. Works by penetrating into pores of fabric, rubber and even hard surfaces to eliminate odor naturally.

7003 8oz.



SILICONE SPRAY

Dry silicone spray for sail luffs, cleats and bearings.

5106 Silicone 11.5oz



MAGICA RUST REMOVER

Easily clean rust stains from fiberglass, plastic surfaces, metal parts or fabrics. Although metal parts are made from high quality stainless steel, machining tools often leave carbon particles imbedded in the metal surfaces. This material can bleed a rust stain onto other surfaces. Magica simply dissolves the rust away.

1603 MAGICA GEL 8 oz. Bottle

HOBIE BOAT CLEANER & UV PROTECTANT SYSTEM: CLEAN AND THEN PROTECT!



HOBIE BOAT CLEANER - 16oz

Formulated with "Green Chemistry" to safely remove dirt and stains from Hobie products. Good on fiberglass, polyethylene, Vinyl (trampolines) and PVC (inflatables). Cleans the most stubborn stains off of hulls.

7005 HOBIE BOAT CLEANER - 16oz

HOBIE UV PROTECTANT - 16oz

Protect and rejuvenate fiberglass, polyethylene, vinyl and PVC materials. Spray on, the protectant absorbs into the material and leaves a UV protective layer. Reduce the loss of essential oils and deflect the sun's harmful UV rays.

7006 HOBIE UV PROTECTANT - 16oz



TEAR-AID

Each TEAR-AID® repair patch is made from an exceptionally tough, matte finish, abrasion resistant, elastomer that resists puncture and tearing. It is combined with an aggressive adhesive formulated for high bond strength to a variety of surfaces such as canvas, leather, rubber, nylon, most plastics, paints, aluminum, stainless steel, fiberglass, polyurethane, polyethylene, polypropylene, vinyl and vinyl coated. TEAR-AID® Type A and TEAR-AID® Type B provide a simple and easy method of patching holes and tears, as well as an excellent protective film solution.

72020030 TEAR-AID / TYPE A (POLY)

72020031 TEAR-AID / TYPE B (VINYL)

EACH PATCH KIT CONTAINS: (1) 3" x 12" TEAR-AID® Patch that cuts with scissors to any size, (1) 7/8" x 7/8" Patch, (1) 1 3/8" x 1 3/8" Patch, (1) 12" Reinforcement Filament for repairing tears at edges, (2) Alcohol Prep Pads, (1) Illustrated Instructions and a Product Repair List.

Serious Fishing



Powered by Hobie's patented MirageDrive® pedal system, the **Hobie Mirage Outback** leaves your hands free for job one—fishing. A wide hull provides form stability, allowing you to cast or reel in the big one—without rocking the boat.

- Large covered bow hatch
- Two 8" Twist and Seal hatches
- Four molded-in rod holders
- Utility trays
- Adjustable high-back padded seat with inflatable lumbar support
- Mesh-covered stowage pocket
- Rear cargo area with Bungee® tie-downs
- Options: Bimini, Dodger, Hobie eVolve™ powered by Torqeedo electric motor kit, plug-in cart, sail package

POWERED BY



HOBIE
MirageDrive®



hobiefishing.com

HOBIE KAYAK SUPPORT / ONLINE SUPPORT - FAQs - FORUMS

For technical help, contact your dealer, see the Hobie website support area or visit our Hobie kayak user forums.

Our on-line support area and forums include FAQs with many technical and user topics.

Hobie Cat Company hobiekatyaks.com / Hobie Australasia hobiecat.com.au / Hobie Kayak Europe hobie-kayak.com

HOBIE KAYAK FAQ

How watertight is my boat? It is normal for any type of kayak to experience a small amount of seepage due to the installation of rivets, hatches, etc. Kayaks may take on a few cups of water while out paddling. If a kayak is taking on more than a small amount of water, check to make sure the drain plug is in, then check the rest of the boat for leaks. Silicone can be used to seal the rivets. If you have any questions, please call your dealer.

How should I store my kayak? It is best to store your kayak upside down or standing on end. If hanging your kayak, do not support from the handles. Best supported by wide webbing straps with the kayak upside down or on its side.

Is my boat repairable? Hobie kayaks are very durable, however, on occasion they may need some minor repairs. Linear polyethylene is repairable. Check with your dealer concerning repairs for your kayak.

Is my boat recyclable? Hobie will recycle your boat when you are done with it. To recycle a Hobie Kayak, it must be cut up so it fits in a box with the following dimensions: may not exceed 130" for the length plus girth, and maximum 108" for the length. Ship the boat to: Hobie Cat 4925 Oceanside Blvd. Oceanside, CA 92056. It is our hope that no Hobie Kayak will ever end up in a landfill!

HOBIE CAT PARTS - WARRANTY POLICY

HOBIE PARTS WARRANTY Hobie Cat warrants all Hobie Cat manufactured parts and accessories against failure due to materials or workmanship defects for a period of one year.

OTHER WARRANTY Any accessories and other merchandise sold by Hobie Cat not mentioned in the paragraph above are not warranted by Hobie Cat. Said accessories and other merchandise may be covered by the manufacturer's warranty, a copy of which can be furnished by Hobie Cat upon written request.

HOBIE CAT'S OBLIGATION Hobie Cat at its option will repair or replace without charge any part or accessory which is found to be defective under the terms and within the period of this Warranty. Buyer must return the accessory with a sales slip as proof of purchase date.

BUYER'S OBLIGATION Upon discovery of a suspected defect, Buyer must-at his/her own expense-promptly return the equipment to the Hobie Kayak dealer for inspection. Warranty is void if equipment is operated after a suspected defect is,

or should have been, discovered.

WHO IS ENTITLED TO WARRANTY Only the original Buyer of the equipment and accessories from Hobie Cat is entitled to warranty. Warranty may not be transferred.

NO WARRANTY OF USED EQUIPMENT Used equipment is sold AS IS; Hobie Cat makes NO WARRANTY concerning its merchantability, condition, durability, age or model year, or fitness for any purpose whatsoever.

MUTUAL AGREEMENTS It is agreed that this warranty sets forth Buyer's exclusive right and remedy against Hobie Cat with respect to the equipment and accessories. It is in lieu of all other express warranties and all implied warranties, including implied warranties of merchantability and fitness. Hobie Cat assumes no other like or unlike liability for loss of cargo, use, profit or consequential damages of any kind in connection with the sale, alteration, use, repair or replacement of equipment or any part thereof.

LIVWELL PARTS

- 72021001 BATTERY
- 72021002 BATTERY CHARGER
- 72021003 SWITCH
- 72021004 INTAKE TUBE ASSY
- 72021023 7" INTAKE TUBE (PRO A)
- 72021005 STRAP SET
- 72021006 BATTERY LID
- 72021007 PUMP CONNECTOR FEMALE
- 72021008 PUMP CONNECTOR MALE
- 72021009 DOWNSPOUT FITTING
- 72021010 INTAKE 90 DEGREE
- 72020015 ROD HOLDER - LIVWELL
- 72021020 DOWNSPOUT TUBE
- 72021021 TERMINAL COVER
- 72021022 ATTWOOD PUMP
- 79050211 DRAIN PLUG



72021001



72021002



72021003



72021004



72021005



72021006



72021007



72021008



72021009



72021010



72020015



72021020



72021021



72021022

HOBIE KAYAK - COMMON PARTS

See model specific pages for model-specific parts

TECH TIP!

DECK FASTENERS Customize your boat with the fasteners of your choice... where you want them. The Hobie screw-in fittings can be easily removed and replaced. Add an extra eye where we placed a hook, a cleat hook where a shockcord end is placed... You choose what works best for you. Use tool #71115101

SCREW-IN FITTINGS



71116001
Padeye



71117001
CLEAT



71115001
Shockcord end



71115101
TOOL SCREW in FITTINGS



10092030 PLUG
SEAT AREA OF
ADVENTURE, KONA,
OUTFITTER, REVOLUTION



79050211 DRAIN PLUG
79050212 O-RING



10091000 DRAIN PLUG



81394001 RUDDER PIN (L)
81394021 RUDDER PIN (R)
2011 CENTERLINE STYLE

SEE RUDDER PAGE 39
FOR RUDDER SYSTEM DETAILS

80020001 RUDDER LINE
REPLACEMENT KIT UNIVERSAL



81023001 SPECTRA CONTROL LINE
8063001 SWEDGE
81400001 TUBING
81405001 TUBE HOLDER
81405101 END CAP



41220001 EYELET POST
8031131 SCREW



71110001 PADEYE
8030031 SCREW
8012001 RIVET



71120001 LASHING HOOK
8030031 SCREW



78510001 Bungee hook
8031961 Screw



78520001 Eyelet hold down
8032121 Screw



2101 -SHOCKCORD
FASTENER, 1/4"



72402001 SEATBACK / PADDLE MODELS 2010
72409001 SEAT STRAP W/HOOK



81266001 SEATBACK / MIRAGE MODELS
81268001 SEATBACK / MIRAGE MODELS 2010
81259001 SEAT STRAP W/HOOK
81266011 SEATBACK GEAR PACK



81265001 SEATBACK PLUG
8031130 SCREW
8080541 WASHER



81265101 SEATBACK
ADJUSTABLE PLUG KIT (PR)

NEWER STEERING

81013001 STEERING HANDLE
8030126 SCREW
88991152 STICKER
81385001 WASHER
88991235 PIN
88991281 CRANK



OLDER STEERING

81015001 - STEERING
HANDLE W/ SET-SCREW

81370001 - CRANK
81372001 - CRANK AI-OUTFIT
H071 SPRING
8080691 NYLON WASHER



81392001 TWIST-N-STOW CONTROL ARM UP/DOWN
81380001 OLDER - CONTROL ARM UP/DOWN
81375001 SPRING
8080691 NYLON WASHER
81035011 BOLTED HANDLE AND CONTROL ARM KIT



81035001 UP / DOWN
HANDLE W/ SET-SCREW



RS316BLK 3/16" Shockcord
RS014BLK 1/4" Shockcord
79538201 WEB PULL TAB



53180011 3/8" Hog ring
21180000 1/2" Hog ring



2008 AND OLDER
81410001 CAM LOCK KNOB
BOLTS VARY BY MODEL



81535001 Mirage Cassette
plug



74075001 PADDLE 2 PC FIBER
74010001 BLADE RIGHT
74011001 BLADE LEFT
74076101 BUTTON



81611101 CLICK-N-GO ASSY (L)
81611201 CLICK-N-GO ASSY (R)
8030791 SCREW
(REQUIRES 3/16" ALLEN "BALL" WRENCH)
81602101 SPRING CLICK-N-GO LEFT
81602201 SPRING CLICK-N-GO RIGHT



72103001 SHOCKCORD END
8031130 SCREW

72104001 HOOK



80012001 Pedal retainer
bungee W/Hook



74049001 PADDLE "T" HANDLE



10730000 Cleat
8030111 Screw



78560001 Mesh STOWAGE pocket
8031501 Screw

8031570 SCREW /
PADDLE KEEPER BUNGEE
79538201 WEB PULL TAB

38120031 PUSH-IN CAP (WHITE)
(UNDERSIDE OF HULL)

71300001 HATCH SEAL "TRIM-LOC"
(TOP GLUED) BY THE FOOT
71302001 HATCH SEAL "TRIM-LOC"
(SIDE GLUED) BY THE FOOT



76050001 BOW/ STERN
HANDLE



71220001 METAL PAD EYE
8030071 SCREW



SEE MIRAGEDRIVE PAGE 38-39
FOR DRIVE DETAILS



10730021 CLEAT "STBD"
10730031 CLEAT "PORT"
8031590 SCREW



84550001 MAST RECEIVER
84560001 MAST TUBE COVER
8031151 SCREW



72012001 - SCUPPER
PLUG QUEST / KONA / OUTBACK



72009001 - SCUPPER PLUG
PURSUIT/ MAUI/ LANAI



72010 -SCUPPER PLUG
ODYSSEY



76055001 Midship handle
8032011 Screw



88991061 Midship Handle
8032011 Screw



71190001 Webbing lift handle
8032011 Screw
8080571 Washer



81408001 HANDLE
81406001 DECAL - UP
81407001 DECAL - DOWN
8004531 LINE (BLK)
81450001 UP / DOWN BLOCK
8031065 10-32 X 7/8 SCREW
8031069 10-32 X 1-1/4 SCREW (AI)
8050211 NUT

HATCHES



71702011 Hatch 8" Twist-N-Seal
71702001 Hatch 8" Twist-N-Seal RETRO KIT
71331001 FLANGE Gasket / 71702021 LID O-RING
8031130 Screw



71130001
Hatch 5" screw-in
8031130 Screw



71701011 Hatch 6" Twist-N-Seal
71701001 Hatch 6" Twist-N-Seal RETRO KIT
71321001 FLANGE Gasket / 71701021 LID O-RING
8031130 Screw

HOBIE MIRAGEDRIVE "V2"

WHAT MAKES A "V2" Drive? V2 DRUMS, V2 CHAINS, V2 IDLER CABLE and V2 (Threaded) mastS / sprockets (2009 PRODUCTION AND NEWER)

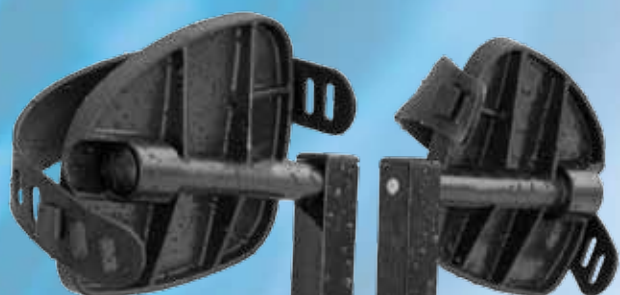

72020034 PEDAL PAD KIT



81172001 PEDAL ADJUSTMENT DECAL

81236001 PEDAL ADJ ASSY

INCLUDES:

- 81240001 PLASTIC HANDLE
- 81230001 PIN
- 8031201 SCREW
- 81242001 SPRING
- 8034071 ALLEN WRENCH



81173001 DRUM V2

81202001 CHAIN ASSY V2

8050111 NUT

81090001 DRUM SHAFT V2 FITS ALL MODELS

DRIVE SEAL

- 81037001 STD
- 81038001 I - SERIES
- 8031581 SCREW
- 8080461 WASHER

81181001 SPINE

81080001 SPROCKET SHAFT 53170020 SET SCREW

81190001 STANDARD FIN 81193001 ST FIN 81192001 ST TURBO FIN

"V2" SPROCKET UPDATE KIT
(2 "V2" SPROCKETS AND 2 "V2" MASTS)
81129022 "V2" STANDARD MAST KIT
81129122 "V2" TURBO MAST KIT

81050001 OUTHHAUL BLOCK 8020041 CLEVIS PIN 10860001 LOCK RING

81055001 SPROCKET GUARD FWD 8031451 SCREW



81129001 SPROCKET "V2" THREADED



81163001 MAST "V2" THREADED 81198101 MAST / ST TURBO "V2" THREADED 8000341 LOC-TITE .5ML

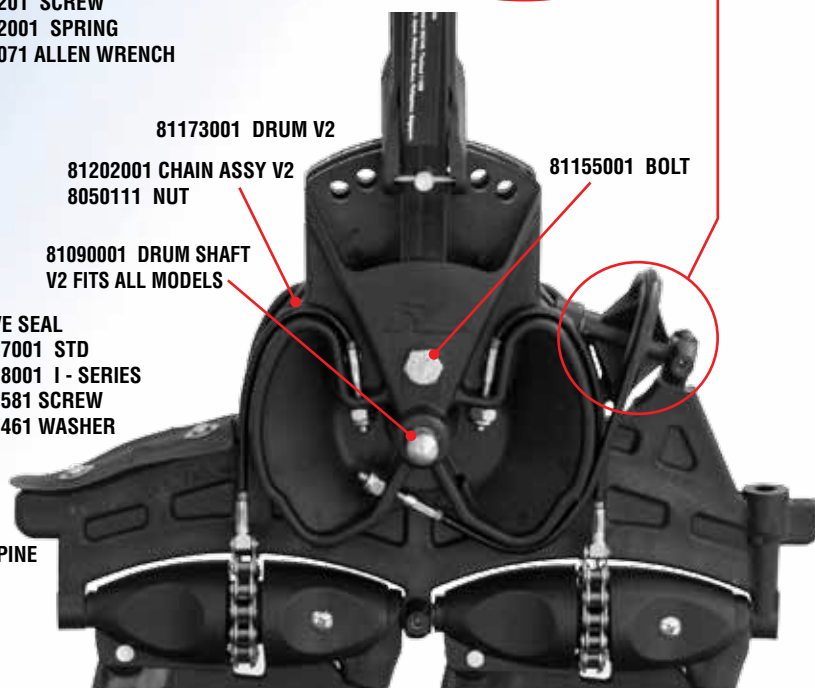
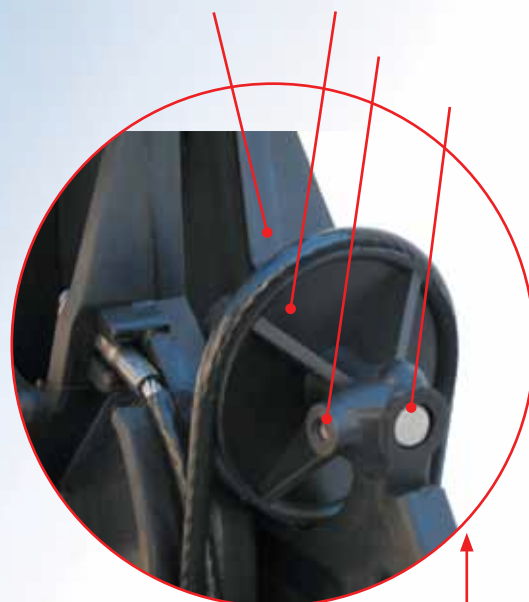

HOBIE MIRAGEDRIVE "V1"

drive with Older p-plastic drum, plastic spine, SPROCKET / MAST CONNECTION IS SET SCREW



HOBIE MIRAGEDRIVE OLDER

ORIGINAL drive with ALUMINUM spine, STAINLESS SPROCKET / MAST CONNECTION IS COTTER KEY

- 81130001 SPROCKET (STAINLESS)
- 81340001 SPROCKET BUSHING (SS SPKT)
- 81420001 SPROCKET GUARD
- 8060111 COTTER KEY (MAST / SS SPKT)
- 81040001 OUTHAUL BLOCK (SS SPKT)
- 8020061 CLEVIS PIN
- 10860001 LOCK RING
- 81211001 IDLER CABLE 14 3/4" (SOLID PULLY)
- 81150001 DRUM BUSHING (ALUM DRUM)
- 81105001 CRANK ARM RIGHT, THREADED
- 81100001 CRANK ARM LEFT, THREADED

RUDDER SYSTEMS

TWIST-N-STOW RUDDER

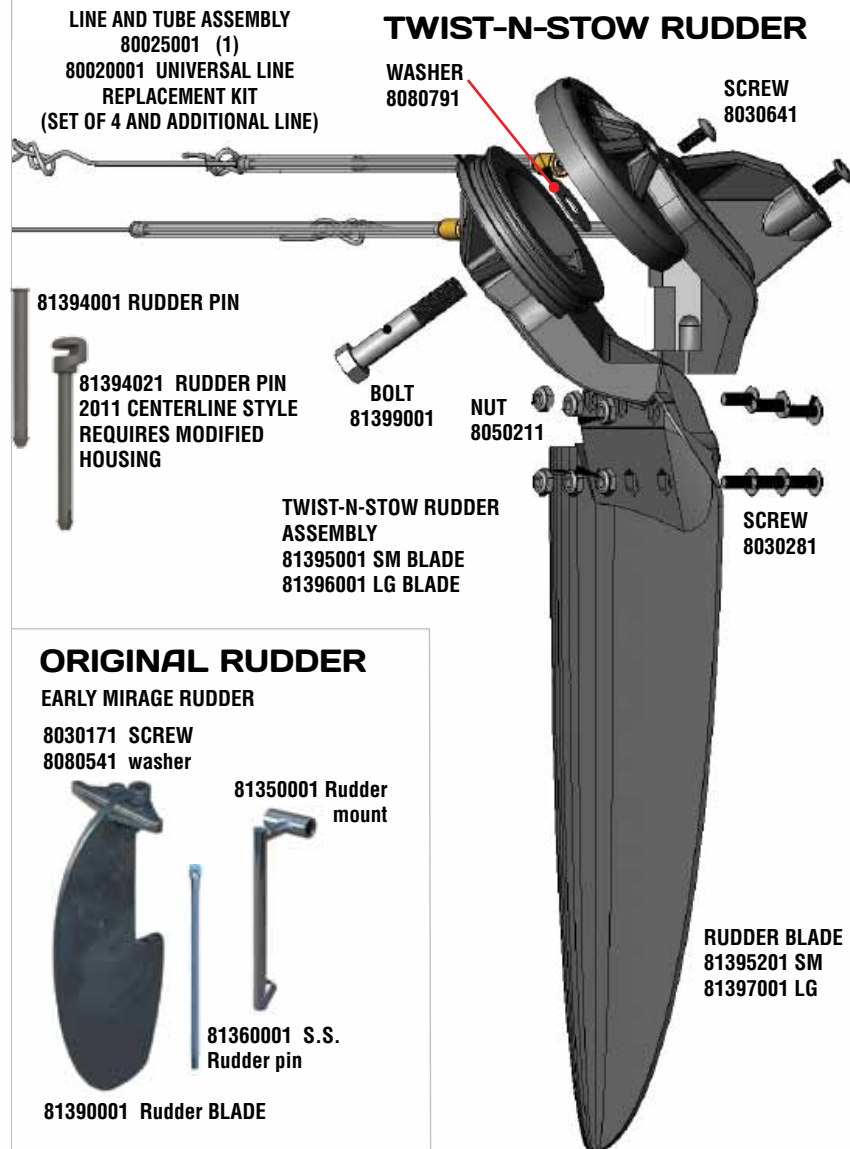

ORIGINAL RUDDER

EARLY MIRAGE RUDDER



MIRAGEDRIVE SPARE PARTS KITS

Spare parts kits include a spare fin, mast, sprocket, chain, clevis pin and ring. All in a handy zippered pouch. Available for the standard fin drives or drives with ST Turbo fins. Standard kit shown.

MIRAGEDRIVE "V2" (THREADED MAST STYLE)

Includes parts listed above for V2 "threaded mast" drives.

- 80010301 KIT "V2" Standard FIN
- 80013301 KIT "V2" Turbo FIN

MIRAGEDRIVE OLDER (SET SCREW MAST STYLE)

Includes parts listed above plus: Set screw, allen wrench, and a cotter key.

- 80010201 KIT Standard FINS
- 80013201 KIT Turbo FINS

TECH TIP

MAINTENANCE AND TUNING - Maintenance and tuning information for MirageDrives and Twist-n-Stow rudder systems is available on the Hobie Cat website support area. www.hobiecat.com/support

Direct link to the support pages for kayaks is here: www.hobiecat.com/support/index-kayak.html

HOBIE MIRAGE SERIES

MIRAGE SPORT



81362001 Rudder pin, OLDER OUTBACK
20860000 Lock ring

MIRAGE OUTBACK

RUDDER LINE REPLACEMENT KIT
80020001 UNIVERSAL



80020001
RUDDER LINE REPLACEMENT
KIT UNIVERSAL

MIRAGE OUTFITTER



81361001 RUDDER PIN, CLASSIC
20860000 LOCK RING

MIRAGE CLASSIC

MIRAGE CLASSIC & PURSUIT
71201 -CARGO COVER
71300001 - LOC SEAL, 6.5FT



MIRAGE REVOLUTION®



WATER BOTTLE GUIDE

71999011 SMALL BOTTLE 160Z
SPORT/OUTBACK/QUEST/KONA

71997001 MEDIUM BOTTLE 180Z
ODYSSEY/LANAI/MAUI

71998001 LARGE BOTTLE 320Z
REVOLUTION/ADVENTURE/ADVENTURE
ISLAND/OUTFITTER/OASIS

MIRAGE OASIS®

RUDDER LINE
REPLACEMENT KIT
80020001

81362001 RUDDER PIN, OLDER TANDEM
20860000 LOCK RING



MIRAGE ADVENTURE

79050211 NEWER DRAIN PLUG

80020001
RUDDER LINE
REPLACEMENT KIT

HATCH SEAL - TRIMLOC
71300001 PER FOOT (5')



HOBIE PADDLE SERIES



LANAI / MAUI

MAUI
6" Hatch

LANAI
6" Hatch

QUEST RUDDER SYSTEM
78501 TWIST-N-STOW RUDDER KIT
78551001 rudder mount TnS
8032011 rudder screws

37380001 CLAM CLEAT



61070000 Cleat
8031130 Screw

KONA



8" Hatch

8" Hatch

QUEST



8" Hatch

HATCH SEAL - TRIMLOC
71300001 per foot (5')

ODYSSEY



8" Hatch

8" Hatch

78540001 TRACK / FOOT BRACE
78535001 FOOT BRACE / LEFT
78536001 FOOT brace / right

HOBIE MIRAGE i - SERIES

79052007 Seatback / i-SERIES

79050061 I-series Cassette plug
79050021 CLICK and GO SPRING

71702011 Hatch 8" Twist-N-Seal
71331001 FLANGE Gasket / 71702021 LID O-RING
8031130 Screw

79052017 VALVE ASSY

81394001 Rudder pin
81395201 SMALL rudder blade
81395001 rudder assy. w/ sm. blade



76050001
Bow/ Stern handle

79050211 DRAIN PLUG

79052019 paddle HOLDER

74077001 paddle 4 PC aluminum shaft

80012001 Pedal retainer bungee W/Hook



79052000



79052006



79052001



79052015 and 16



79052009

79052000 i - ACCESSORY HOLDER KIT

Designed to allow the attachment of rod holders and other accessories to the Hobie Mirage inflatable kayaks. The accessory kit comes with 2 mount plates and attachment glue. 4 hole pattern fits Scotty mount and RAM / Scotty hole pattern products. Mount the 80052001 Scotty Deck/Side mount and Scotty rod holders or adapt for the RAM products by adding 72023004 RAM Ball Scotty adapter. (1/4-20 Screws sold separately, check length for desired accessory / #8030380 7/8" length for Scotty deck mount).

79052006 i - HARDWARE ACCESSORY KIT

Includes padeyes, spare cleats and glue. Customize your Hobie inflatable.

79052001 i - CAN HOLDER KIT

Includes 2 flexible can / cup holders and glue. Customize your Hobie inflatable.

80045101 i - KAYAK CART "PLUG-IN"

79052015 i - TRI RING KIT / SAGE

79052016 i - TRI RING KIT / SUNDANCE

Includes 2 "Tri" rings mounted on round patches ready for installation. Customize.

79052009 i - HULL REPAIR KIT

Includes 2 colors of repair vinyl and glue, valve tool and instructions. Repair or customize a Hobie Mirage Inflatable kayak.

79052005 i - ELECTRIC INFLATION PUMP

Electric pump connects to car 12v outlet. Quickly and easily fill your Hobie inflatable. This is a high volume / low pressure pump. Use the standard pump to bring chambers to full pressure.

79052003 i - STANDARD INFLATION PUMP

Standard hand pump for Hobie inflatable.

ADVENTURE ISLAND

79510001 '07 MAST ISLAND (2 PC)
79510011 '08 MAST ISLAND (2 PC)
79511021 MAST SWIVEL TIP

79512001 FURLER DRUM
79511001 '07 MAST BASE / PIN
79511101 '08 MAST BASE / HOLE
79510101 MAST BASE COLLAR KIT

'07 BASE COLLAR KIT



79509001 SAIL GRAY/WHT
79516001 SAIL PAPAYA/TURQ/WHT
79515001 SAIL RED/GRAY/WHT

91051011 BATTEN 9' 2"
91041011 BATTEN 7' 8.5"
91011001 BATTEN CAP
22080011 BATTEN LUFF CAP SET

79531001 XBAR FWD ASSY
8030781 SOC CAP SCREW

79520001 AKA FWD (L/R)

79535001 AKA CONNECTOR PIN
RS316BLK 3/16" SHOCK CORD (9")
53180011 HOG RING



71190001 LIFT HANDLE
8032011 SCREW
8080571 WASHER

79545001 AMA "HOBIE" DOME LOGO

88991355 2011 STEER KNOB ASSY

79538101 PADDLE HOLDER KIT
79538001 PADDLE RETAINER CLIP

79521001 AKA LEFT REAR

2011 MODEL AI (V2) XBAR / AKAS

79512201 AKA AI V2 - RT FWD
79512301 AKA AI V2 - LT FWD
79512401 AKA AI V2 - LT REAR
79512501 AKA AI V2 - RT REAR
79512601 XBAR AI V2 - FWD
79512701 XBAR AI V2 - REAR

38670011 "S" HOOK

H082 BULLET BLOCK

H083 BULLET BLOCK W/BECKET

79526001 AKA CARRY BAG

79510201 MAST / SAIL BAG



79533001 MAST BEARING PLATE (REQ 2)
8031231 SCREW
8050801 NUT
90610111 BEARINGS (EA / REQ 24)
79532001 MAST RETAINER SPRING
8004381 (12') FURLING LINE

H233 CHEEK BLOCK
8030150 SCREW
8080500 WASHER
8050211 NYLOCK NUT

H424B FAIRLEAD
H471 CLEAT

8031481 SCREW
79531101 CLEAT WEDGE WITH FAIRLEAD
79531111 MAIN CLEAT WEDGE
RMO14BLK MAINSHEET (32')

79501001 FOAM PLUG /
DAGGER WELL

79502001
DAGGER BOARD

79525001 BALL / BRACE
8030212 SCREW

79522001 AKA RIGHT REAR

79537001 BRACE RETAINER CLIP

79530001 XBAR REAR ASSY
8030781 SOC CAP SCREW

79523101 AKA BRACE ASSY V1 (L)
79523102 AKA BRACE ASSY V1 (R)

79523201 AKA BRACE ASSY - V2 (L)
79523202 AKA BRACE ASSY - V2 (R)

79524001 CAP / AKA BRACE LOCK
79523001 SOCKET / AKA BRACE LOCK
81242001 SPRING / AKA BRACE LOCK
8030781 SOC CAP SCREW

10091000 DRAIN PLUG

81396001 TWIST-N-STOW RUDDER ASSY / LG BLADE
81397001 LARGE SAILING RUDDER BLADE
81394001 RUDDER PIN
81394021 RUDDER PIN 2011 CENTERLINE STYLE

79050211 DRAIN PLUG
79050212 O-RING

79514001 '07 MAST RECEIVER
79514101 '08 MAST RECEIVER
8030261 SCREW
8080211 WASHER

71320001 GASKET

79513001 BACKUP RING



8032011
STEP PLATE
SCREW

79519001 V-FRAME
TURNBUCKLE

79518001
V-FRAME BASE



71116001 EYE



71115001 END FITTING
RS014BLK SHOCK CORD (1')



41220001 EYELET POST
8031130 SCREW



79520201 AKA COLLAR
8010181 RIVET



79520301 AKA END CAP

99303001 AMA PAPAYA
99304001 AMA HIBISCUS
99305001 AMA DUNE



10091000 DRAIN PLUG

79050211 DRAIN PLUG
79050212 O-RING

8032081 SHEAR BOLT
8052081 NUT
79536001 BRACE CONNECTOR
8020381 CLEVIS PIN
20860000 SPLIT RING

81391002 RUDDER UP/DOWN LINE KIT

80020001 RUDDER LINE
REPLACEMENT KIT UNIVERSAL

TANDEM ISLAND

88991121 MAST TANDEM ISLAND (2 PC)
79511021 MAST SWIVEL TIP
88991071 FURLER DRUM
79511101 MAST BASE

88998514 SAIL DUNE
88998515 SAIL SMOKE
88998516 SAIL BREEZE



BATTEN CAP

88998521 BATTEN #1 (3/8" 186")
88999519 BATTEN CAP 3/8"
88998522 BATTEN #2 (3/16" 42 1/2")
88998523 BATTEN #3 (3/16" 39 1/2")
91011001 BATTEN CAP 3/16"

22080011 BATTEN LUFF CAP SET

79520311 AKA FWD (L)

79531201 XBAR FWD ASSY
8030451 SCREW (CUP ATTACH)
8050111 NUT (CUP ATTACH)

71190001 AMA LIFT HANDLE
8032011 SCREW
8080571 WASHER
79545001 AMA "HOBIE" DOME LOGO

88991061 HULL LIFT HANDLE
8032011 SCREW

88991301 STEERING HANDLE
88991235 ROLL PIN
8030125 SCREW
88991151 STICKER
88991355 (2011) STEER KNOB ASSY

79530201 XBAR REAR ASSY

79520401 AKA LEFT REAR

79538101 PADDLE HOLDER KIT
79538001 PADDLE RETAINER CLIP

79050211 DRAIN PLUG
79050212 O-RING

79526002 AKA CARRY BAG

79510202 MAST / SAIL BAG



79533001 MAST BEARING PLATE (REQ 2)
8031231 SCREW
8050801 NUT
90610111 BEARINGS (EA / REQ 24)
79532001 MAST RETAINER SPRING
8004381 (12") FURLING LINE

H233 CHEEK BLOCK
8030150 SCREW
8080500 WASHER
8050211 NYLOCK NUT
79510721 XBAR CLAMP TOP
79510731 XBAR CLAMP BOTTOM
8032088 SCREW
8080561 WASHER

79520211 AKA FWD (R)



H424B FAIRLEAD
H471 CLEAT 8031481 SCREW
79531101 CLEAT WEDGE / FAIRLEAD
79531111 MAIN CLEAT WEDGE

88991101 CENTERBOARD
88991021 CENTERBOARD PIN
88991031 PIN HOLDER
8031461 SCREW
8030671 SCREW
88991011 COVER
8030071 SCREW (4)
81242001 SPRING
88991041 KNOB
88991150 CAP

79520501 AKA RIGHT REAR

79537001 BRACE RETAINER CLIP

79525001 BALL / BRACE
8030212 SCREW

MAINSHEET SYSTEM
38670011 "S" HOOK
H083 BLOCK-BULLET W/BECKET
RM014BLK LINE (55')
H2655 BLOCK, 40MM CARBO FIDDLE

79050211 DRAIN PLUG
79050212 O-RING

RUDDER UPDATED SPRING 2011
CONTACT DEALER FOR RUDDER DETAILS



79514101 MAST RECEIVER
8030261 SCREW
8080211 WASHER
71320001 GASKET
79513001 BACKUP RING

8032011 STEP PLATE SCREW

88991191 V-FRAME STRUT
79528001 SCREW SOCKET SET

88991201 V-FRAME
TURNBUCKLE

8050111 NUT

88991201 V-FRAME BASE



71116001 EYE



71115001 END FITTING
RS014BLK SHOCK CORD (1')



41220001 EYELET POST
8031130 SCREW



79520201 AKA COLLAR
8010181 RIVET



79520301 AKA END CAP

88991303 AMA PAPAYA
88991304 AMA HIBISCUS
88991305 AMA DUNE

88523101 AKA BRACE ASSY (L)
88523102 AKA BRACE ASSY (R)



79524001 CAP / AKA BRACE LOCK
79523001 SOCKET / AKA BRACE LOCK
81242001 SPRING / AKA BRACE LOCK
8030781 SOC CAP SCREW
8032081 SHEAR BOLT
8052081 NUT
88536001 BRACE CONNECTOR
8020381 CLEVIS PIN
20860000 SPLIT RING

80020001 RUDDER LINE
REPLACEMENT KIT UNIVERSAL

PRO ANGLER

ROD HOLDER STORAGE

84500911 ROD HOLDER ASSY LEFT
84500921 ROD HOLDER ASSY RIGHT

84502001 MOUNTING BOARD, RT
84502101 MOUNTING BOARD, LT
8030341 SCREW
8032085 SCREW
8050111 NUT

84502401 FLOOR MAT RT
84502501 FLOOR MAT LT-BLK

STEERING (PRO A) REVERSIBLE ASSY
KIT INCLUDES ALL PARTS TO REPLICATE
2011 STEERING ON OLDER MODELS.
MOUNT ON PORT OR STARBOARD SIDES
84506201

84506001 STEERING ASSEMBLY
(INCLUDES HANDLE, TUBES AND LINE ASSEMBLED)

84501301 HANDLE
84501531 BALL
8030111 SCREW
8050211 WASHER

See Tension Knob

8030981 SCREW
8050211 NUT

81023001 SPECTRA
CONTROL LINE (14')

84501511 TENSION KNOB
84501521 RBR WASHER
8080551 WASHER
8050231 NUT
84502601 TENSION SCREW

84501401 HOUSING
8030981 SCREW (2)

84501601 TUBE CONNECTOR, STEERING

80074001 STEERING LINE TUBE (2)
8003171 BLK PVC TUBE COVER (26")
84501201 THRU HULL BARB CONNECTOR
81030001 ZIP TIE (BLK) (2)

84500601 COVER PLT, RDR SYSTEM
8031051 SCREW (4)
84500801 TUBE RESTRICTOR (2)
84500501 RDR STEERING DRUM
81245001 ROLL PIN
84500201 RUDDER HOUSING, UNDER HULL
84502301 SISTER SCREW, PRO RDR ASSY
8031490 SCREW
84500401 RDR MOUNT, UNDER HULL
84504001 TORSION SPRING, RUDDER
84500101 RUDDER BLADE, PRO A

84504501 HANDLE - BOW
8030361 SCREW SOC CAP
79545001 "HOBIE" DOME LOGO

71305001 HATCH SEAL
(7.25')



84501901 HATCH LINER FWD - PRO ANGLER

72020311 PLANO BOX - SMALL YELLOW
72020321 PLANO BOX - MEDIUM BLUE
72020331 PLANO BOX - LARGE RED



84505001 STORAGE BUCKET ASSY
(INCLUDES COMPARTMENT WITH DIVIDERS)
84505101 STORAGE BUCKET COMPARTMENT
84505201 REPLACEMENT COMPARTMENT DIVIDERS
(SOLD AS EACH / REQ 7)

84502201 CUTTING BRD, CNTR, BLACK
8030071 SCREW
8050111 NUT

84500001 SEAT ASSEMBLY - PRO ANGLER
84500011 LUMBAR SUPPORT PAD
84502901 KNOB, SEAT FRAME FRONT
8031811 STUD (FWD)
8042151 BOLT SHOULDER (REAR)
84500021 SEAT STRAP ASSY (ONE SIDE)
8011231 RIVET
84500031 STAINLESS REPLACEMENT BUCKLE

84504101 UNIVERSAL SIDE HANDLE ASSY
84504401 HANDLE END FITTING
8031781 SCREW SOC CAP
84504301 DECAL, RULER

71996001 BOTTLE/CAN HOLDER
74035001 FOLDING PADDLE CLIP

71702011 HATCH 8" TWIST-N-SEAL

84504201 TUBE, STERN HANDLE
84504401 HANDLE END FITTING
8031781 SCREW SOC CAP

72013001 SKID GUARD, PRO
8030641 SCREW
10091000 DRAIN PLUG

INDEX

OS = Oversized item / AH = Additional handling charges apply

OS

Part	Description		
278	WINDTRONIC 2 W/ BELT POUCH	8031191	SCREW 1/4-20 X 1-1/4"PHMS
330	WIND METER HAND HELD-MPH	8031201	SCREW 8-32 X 1-1/4 SOC SET CUP
334	AIR FLOW TELS, RED / GREEN	8031231	SCREW 8-32 X 7/8" FHMS
370	SHOCK CORD BALL TIES	8031451	SCREW #8-32 x 5/16 P-THMS SS
376	SILICON RTV 100% 3 OZ.	8031461	SCREW 8-32 x 1" PHMS
615	BOOK, PENGUIN BOAT FLIPPERS	8031481	SCREW 8-32 X 1-1/4 PHMS-P
1550	KNIFE, STD. STAINLESS RIGGING	8031490	SCREW 8-32 X 1/2 FHMS-P
1551	KNIFE, DLX STAINLESS	8031581	SCREW #8 X 5/8" PHSMS-SS PH
1555	KNIFE, YACHTSMAN POCKET	8031590	SCREW 8 X 3/4" FHSMS-P SS
1603	MAGICA RUST REMOVER GEL 8 OZ B	8031781	SCREW 5/16-18 X 1 E/S SOC
1619	TRAMP CLEANER,SEASPRAY	8031811	STUD 5/16-18 X 1-1/4" 18-8 SS
2082	SCALE - DOWN HAUL / FISH	8031961	SCREW 12-24 x 1-1/4 P-OHMS SS
2101	SHOCK CORD HOOK 1/4" - HOBIE	8032011	SCREW 1/4-20x1/2 RHMS-P SS
2102	SHOCK CORD FASTENER (SCH) 5/16	8032061	SCREW 1/4-20x1 1/4 PHPMS
2105	SHOCK CORD HOOK 1/4"	8032081	SCREW 1/4-20 X 1-1/4 CAP SCREW
3043	LICENSE FRAME - CHROME "HOBIE"	8032085	SCREW 1/4-20 X 1-1/4 FHMS-P
3044	LICENSE FRAME - CHROME "KAYAK"	8032088	SCREW 1/4-20 x 2-1/4 HX CAP
3062	SHACKLE, FAST	8034061	ALLEN WRENCH 1/8"
3091	PADDLE, TELESCOPING 20"-3'9"	8034071	ALLEN WRENCH 5/64"
3103	BLOCK, MINI W/AXLE	8040131	BOLT 1/4-20 X 3 1/2
5106	SILICONE SPRAY 11.5oz	8040526	BOLT, CAM LOCK KNOB, 3.25 " NO
5411	FAT BAG-5"	8040531	BOLT 3/8-16 X 1-1/2 HEX CAP-S
5421	HATCH BAG KIT KAYAK	8040535	BOLT 3/8-16 x 1-3/4" SCKT HEAD
7003	MIRA ZYME 8 oz ODOR ELIMINATOR	8042151	BOLT 5/16-18 X 1/2 SHOULDER
7005	HOBIE BOAT CLEANER - 16oz	8050111	NUT 1/4-20 HX NYLOCK
7006	HOBIE UV PROTECTANT - 16oz	8050211	NUT 10-32 NYLOCK LOPRO
7904	VELCRO ONE WRAP 1" BLACK	8050221	NUT (WELL NUT) 10-32 x1
20501	HAIRPIN COTTER 5/16" 302 SS	8050231	NUT 10-32 HEX
71172	B/U RING 8.0" FOR PTL-8	8050540	NUT 3/8-16 HX NYLOCK-LP
71201	CARGO COVER ASSY-PUR/MIR	8050801	NUT 8-32 MACH/SCREW SS
71311	GASKET KAYAK 5"	8052081	NUT 1/4-20 NYLON BLK
72010	KEY FLOAT/SCUPPER PLUG	8060111	COTTER PIN 3/32 X 3/4 SS
72035	QUICK STRAP SOFT RACK-24.0"	8061961	SCREW 12-24 x 1-1/4 P-OHMS SS
72040	QUICK STRAP RACK W/TIE DN	8063001	SLEEVE MICROPRESS 1/16"
72041	MULTI STRAP SYSTEM	8080211	WASHER #12 FLAT
72042	TIE DOWN STRAPS - 12 FOOT	8080461	WASHER #10 FLAT-.25 OD X .56 I
72043	TIE DOWN STRAPS - 15 FOOT	8080500	WASHER #10 FINISH
72045	RACK PADS -24.0"	8080541	WASHER 1/4 X 5/8 FLAT SS
72046	RACK PADS -36.0"	8080551	WASHER-FLAT .227 X .453 SS
72047	STEEL-CORE TIE DOWN 12FT (PAIR	8080561	WASHER 1/4 X 1/2 X .032 SS
72048	STEEL-CORE TIE DOWN 15FT (PAIR	8080571	WASHER FLAT 1/4x3/4x.063 SS
72050	KAYAK COVER / 9-12'	8080691	WASHER 3/8 X 3/4 NYLON-FLAT
72051	KAYAK COVER / 12-15'	8080731	WASHER #10 FNDR SS
72052	KAYAK COVER / 14-16'	8080791	WASHER NYLON FLAT (TNS)
72053	KAYAK COVER / 14-16' 6"	10091000	DRAIN PLUG W/GASKET
72054	KAYAK COVER / 16-18' 6"	10092030	DRAIN PLUG w/GASKET- SEAT: KON
72065	ST-TURBO FIN KIT	10730000	CLEAT-MAST
72080	MINI KAYAK CART	10730021	CLAMCLEAT STBD BLACK
72700	BIMINI / CHARCOAL - MANTIS JR	10730031	CLAMCLEAT PORT BLACK
72701	BIMINI / BLUE - MANTIS JR PRO	10860001	LOCK RING 3/16"
72702	BIMINI / GREEN - MANTIS JR PRO	10860100	LOCK RING 3/16" - 100 PACK
72710	MOUNT - BIMINI MANTIS JR PRO	10870000	SHACKLE "BOW" 4.7 MM
72720	KAYAK DODGER - CAMO	11220000	SHACKLE STND "D" 4.7 MM
72721	KAYAK DODGER - SILVER	12451021	DECAL "HOBIE" DIAMOND-RED/SLVR
72722	KAYAK DODGER - YELLOW	12451031	DECAL "HOBIE" DIAMOND-TURQ/SLV
78501	QUEST RUDDER KIT/TWIST N STOW	12451050	DECAL "HOBIE" SCRIPT BLACK
80024	BAG, MIRAGEDRIVE CARRY	12451051	DECAL "HOBIE" SCRIPT WHT
80039	COOLER, KAYAK BLUE	12453011	DECAL - HOBIE KAYAKS
80041	KAYAK CART - "HEAVY DUTY"	12453021	DECAL - HOBIE KAYAK FISHING
80043	PLUG IN CART HD UPGRADE KIT	12453031	DECAL - HOBIE CAT TEQ
81024	LINE 5/32" NYLON BRAID-BLACK	13001001	DECAL BOW - FLYING "H" BLK
81380	CONTROL ARM - UP/DOWN	20860000	LARGE CLEVIS RING
83102	TOOL GERBER MULTI-PLIER 600	20860100	LARGE CLEVIS RING / 100 PACK
83104	TOOL, HOG RING PLIERS	21180000	HOG RING 1/2" S/S, BLUNT, 14 G
84503	SAIL KAYAK MAST 2-PC	22080011	JIB BATTEN PKT PROT W/SCREWS
84511	BATTEN KAYAK SAIL 4.583 FT	36601000	DECAL FLYING "H" SMALL BLK
84950	BAG - KAYAK SAIL RIG	36601011	DECAL FLYING "H" SMALL WHT
84960	MIRAGE TDM SAIL ADAPTER KIT-SM	37380001	CLAMCLEAT MINI GETAWAY
84961	MIRAGE TDM SAIL ADAPTER KIT-LG	38120031	NYLON PUSH-IN PANEL RIVET
8000341	LOCTITE BLUE .5 ML CAPSULE	38652000	TRAILER HOBIE ALUM KAYAK SINGL
8003171	TUBE 1/2" ID X 5/8" OD-PVC BLK	38652200	TRAILER HOBIE ALUM KAYAK DOUBL
8004381	LINE 5 MM, DK GRAY w/MANGO TRA	38652201	TRAILER ALUM KAYAK DOUBLE DOUB
8004531	LINE 1/8 NYLON BRAID BLK	38652210	TOWER - TRAILER HOBIE ALUM DOU
8010181	RIVET 6-4 PN HD	38653300	TRAILER PAD KIT - KAYAKS
8012001	RIVET 6-9 BULB TYPE-KAYAK	38670011	"S" HOOK,WAVE HALYD DWNHL
8020041	CLEVIS PIN 3/16x.570 GRIP	41220001	EYELET POST
8020061	CLEVIS PIN 3/16x.753 GRIP	41370001	HATCH SCREW-IN W/LIP-WHT 5"
8020381	CLEVIS PIN 1/4x.578 GRIP	53170020	SCREW 1/4-20 X 1/2 SKTST (ABA)
8030031	SCREW #10x3/4 OHMS-P	53180011	HOG RING 3/8" S/S FOR 3/16" BU
8030037	SCREW #6-32 x 3/4 PHMS	53410061	LINE HANGER
8030071	SCREW 10-32 X 1/2 FHMS	61070000	CLAMCLEAT JUNIOR CL203
8030111	SCREW 10-32 X 1 PHMS-P SS	71110001	PAD EYE-BLK NYLON-3/8"
8030125	SCREW 10-32 x 1/2 BTN HD SCKT	71115001	SHOCK CORD END - SCREW-IN (UAI
8030126	SCREW 10-32 x 3/8 FLNG BTN HX	71115101	TOOL - SCREW IN FITTINGS
8030150	SCREW 10-32 x 1/2 PHMS-P	71116001	PADEYE - SCREW-IN (UAI)
8030161	SCREW 10-32 X 1-1/2 RHMS-P SS	71117001	CLEAT - SCREW-IN
8030171	SCREW 12-24 X 3/4 RHMS-P SS' (71120001	LASHING HOOK-BLACK
8030212	SCREW 1/4-20 X 1" OHMS-PH SS	71130001	HATCH SCREW-IN w/LIP-BLK 5"
8030251	SCREW 10-32 X 1" FHMS	71171001	B/U RING W/LIP FOR PTL-6
8030261	SCREW #10 X 1-1/4 PHSMS-P	71175001	HATCH BAG 6.0 DIA.-RED
8030281	SCREW 10-32 X 3/4" RHMS-P SS	71190001	HANDLE - LIFTING (WEB - KAYAK)
8030361	SCREW 5/16-18 X 1-1/4 SOC HD	71220001	PAD EYE - CHROME
8030451	SCREW 1/4-20 X 1-3/4 SCKT HD	71230001	COVER, ROD HOLDER
8030641	SCREW 10-32 X 1/2 THMS-P SS	71250001	SHOCK CORD ASSY, KONA FWD DECK
8030671	SCREW 8-32 X 5/8 PHMS-P	71251001	SHOCK CORD ASSY, PDL HOLDER
8030781	SCREW 1/4-20 X 1/2" SOC CAP	71253001	SHOCK CORD ASSY, ADV PDL HOLDE
8030791	SCREW 1/4-20 X 5/8 SOC CAP	71300001	TRIM-LOC SEAL (TOP GLUED)
8030981	SCREW 10-32 x 3/4 PHPMS	71302001	TRIM-LOC SEAL (SIDE GLUED)
8031051	SCREW #10 X 1/2 FHSMS-P TF	71320001	GASKET 5.0" & 7-1/8" SET
8031065	SCREW 10-32 x 7/8" THMS-P	71321001	GASKET KAYAK HATCH 6"
8031069	SCREW 10-32x 1-1/4 THMS-P	71330001	GASKET - SCOTTY ROD HLDR MOUNT
8031081	SCREW 10-32 x1 3/4 PHMS-S SS	71331001	GASKET KAYAK HATCH 8"
8031111	SCREW 1/4-20x1 PHMS -P	71552001	SHOCK CORD ASSY, ADV FWD HATCH
8031131	SCREW #10x 3/4 PHSM-PH SS(ABA	71554001	SHOCK CORD ASSY, QUEST
8031151	SCREW #10 X 1/2 PHSMS-P TF-16	71701001	HATCH 6" TWIST-N-SEAL RETRO
		71701011	HATCH 6" TWIST-N-SEAL

INDEX			
71701021	O RING 6" TWIST-N-SEAL	72022132	EVOLVE v2 - BATTERY CHARGER
71702001	HATCH 8" TWIST-N-SEAL RETRO	72022134	EVOLVE v2 CABLE, PWR EXT, 170"
71702011	HATCH 8" TWIST-N-SEAL	72023000	RAM TUBE ROD HOLDER W/ BASE
71702021	O RING 8" TWIST-N-SEAL	72023001	RAM SMALL DIAMOND BASE 1" BALL
71703001	HOBBIE DRY BAG 8.0"	72023002	RAM SPACE SAVER BASE 1.5" BALL
71704001	GEAR BUCKET	72023003	RAM TUBE BASE 2 X 2.5
71705001	GEAR BUCKET BAG	72023004	RAM POST CONV. ATTWOOD,SCOTTY
71706001	GEAR BUCKET 3 PAK W/BAG	72023006	RAM UNIV MOUNT 6 1/4 X 2
71995001	WATER BOTTLE - STAINLESS	72023007	RAM FISHFINDER MOUNT COMPACT S
71996001	BOTTLE/CAN HOLDER	72023008	RAM FLY ROD HOLDER W/ BASE
71997001	WATER BOTTLE MED SMOKE 18oz	72023010	RAM TUBE ROD HOLDER - NO BASE
71998001	WATER BOTTLE LARGE SMOKE 32oz	72023013	RAM TUBE (PLASTIC PIVOT) ROD H
71999011	WATER BOTTLE SMALL SMOKE 16oz	72023014	RAM TUBE (PLASTIC) ROD HOLDER*
72009001	SCUPPER PLUG-PSUIT/MAUI/LANAI	72023015	RAM MAST-TUBE WEDGE MOUNT 1.5"
72012001	SCUPPER PLUG KONA/QUEST	72023016	RAM MAST-TUBE WEDGE MOUNT 1"
72013001	SKID GUARD, PRO	72023017	RAM U-BOLT 1" RAIL BASE w/BALL
72020000	HOBBIE GEAR KEEPER 2.5oz 36"	72023018	RAM MOUNT LOWRANCE ENDURA
72020001	HOBBIE GEAR KEEPER 36"	72023021	RAM FISHFINDER MOUNT - FULL SI
72020002	SAFETY FLAG 4' (W/STUD)	72023022	RAM TUBE 2000 HOLDER w/FLUSH M
72020003	HYDRO STAR SOS DLX LIGHT	72025001	BATTERY - 12v FISHFINDER
72020004	RITCHIE COMPASS PANEL MNT X-21	72025002	CHARGER - 12v BATTERY FISH F
72020005	FISHFINDER - LOWRANCE X-4 PRO	72025003	PIGTAIL WIRE / 12v FISHFINDER
72020007	HOBBIE LIVEWELL	72062001	SIDEKICK - LOCK PIN SINGLE
72020008	HOBBIE ANCHOR TROLLEY KIT	72062011	SIDEKICK - MOUNT BRACKET BOTTO
72020009	HOBBIE DRIFT CHUTE	72062021	SIDEKICK - MOUNT BRACKET TOP
72020010	HOBBIE SAFETY KIT	72062041	SIDEKICK - CROSSBAR MIDDLE
72020011	FISHFINDER INSTALLATION KIT	72062061	SIDEKICK - ADP PLATES +07 ADVE
72020012	MOUNT - SAFETY FLAG	72062062	SIDEKICK - MOUNT KIT W/CTR BAR
72020013	KAYAK GUN MOUNT (PAIR)	72062101	SIDEKICK AMA KIT - LT GRAY
72020014	ROD HOLDER EXTENSION	72062111	SIDEKICK - FLOAT LT GRAY W/ QU
72020015	ROD HOLDER - LIVEWELL w/FASTEN	72062201	SIDEKICK - BENT ARM
72020016	FISHFINDER-LOWRANCE X67C	72063101	SIDEKICK AMA KIT - DK GREEN
72020017	FISHFINDER/GPS-LOWRANCE M68C	72063111	SIDEKICK - FLOAT DK GREEN W/ Q
72020018	GPS ENDURA-OUT&BACK	72066001	ST-TURBO FIN KIT V2 - THREADED
72020019	FISH GRIP	72076001	STAKEOUT POLE - KAYAK FISHING
72020020	FISHFINDER PACKAGE	72088001	KAYAK STAND 31" (PR) TALIC
72020021	ULTIMATE KAYAK FISHING PACKAGE	72097001	KC WELDER PRO WITH ROD STOCK
72020022	KAYAK FLY FISHING PACKAGE	72103001	SHOCK CORD MOUNT
72020023	KAYAK CUSTOMIZATION PACKAGE	72104001	ADJ SHOCK CORD HOOK 3/8"
72020024	MIRAGE PERFORMANCE PACKAGE V2	72402001	KAYAK SEAT - PADDLE 2010
72020025	KAYAK TRAVEL PACKAGE	72409001	STRAP W/HOOK - PADDLE SERIES
72020026	KAYAK SAFETY PACKAGE	72500001	STRAPS THIGH CNTRL PADDED ASSY
72020028	MIRAGE SEAT PAD - INFLATABLE	72730001	DODGER - ISLAND / YELLOW
72020029	HOBBIE SAFETY PACKAGE-DELUXE	72730002	DODGER - ISLAND / SILVER
72020030	TEAR-AID / TYPE A (POLY)	72730003	DODGER-PRO ANGLER CAMO
72020031	TEAR-AID / TYPE B (VINYL)	74010001	PADDLE BLADE RIGHT
72020032	BILGE - HAND PUMP	74011001	PADDLE BLADE LEFT
72020033	ULTIMATE KAYAK NAVIGATION PACK	74035001	FOLDING PADDLE CLIP, 1-1/8"
72020034	PEDAL PAD KIT BLACK (PAIR)	74049001	T- HANDLE, PADDLE
72020036	FISHFINDER-LOWRANCE MARK PRO	74050001	PADDLE LEASH-WEB/ELASTIC
72020037	FISHFINDER-LOWRANCE ELITE-5X	74051001	PADDLE LEASH-COIL
72020038	FISHFINDER/CHART PLOTTER-LOWRA	74052001	HOBBIE FISH ROD LEASH- WEBBING
72020039	FISHFINDER FULL SIZE INSTALL K	74052101	LEASH KIT - MIRAGEDRIVE
72020040	SAFETY FLAG/LIGHT COMBO	74075001	PADDLE 230 cm HOBBIE FIBER SHAF
72020041	HATCH LINER FWD - OUTBACK	74076101	BUTTON ASSY - PADDLE FERRULE
72020042	HATCH LINER FWD - REVO	74077001	i - PADDLE, 4 PIECE
72020300	KAYAK RIGGING KIT - HARDWARE	76050001	HANDLE KAYAK (MOLDED)
72020311	TACKLE BOX - SMALL YELLOW	76055001	HANDLE, MIDSHIP
72020321	TACKLE BOX - MEDIUM BLUE	78000001	OWNER'S MANUAL-QUEST
72020331	TACKLE BOX - LARGE RED	78510001	BUNGEE HOOK
72020400	CRADLE SET - ADV ISL TRAILER	78520001	EYELET HOLD DOWN
72020401	CRADLE SET - PRO ANGLER TRAILE	78535001	FOOT BRACE ASSY-LT
72020402	CRADLE SET - TDM ISL TRAILER	78536001	FOOT BRACE ASSY-RT
72020500	HOBBIE EXPANDABLE UPRIGHT	78540001	TRACK ADJ - BRACE/QUEST
72020501	HOBBIE WHEELED DUFFEL	78551001	RUDDER BRACKET - QUEST (T-N-S)
72020502	HOBBIE BACK PACK	78560001	MAP POCKET FRAME w/MESH
72021001	BATTERY - LIVEWELL	79050011	CAM LEVER / CLICK-N-GO WELL
72021002	BATTERY CHARGER - LIVEWELL	79050021	SPRING / i - CLICK-N-GO WELL
72021003	SWITCH - LIVEWELL	79050041	BOLT, SHOULDER 1/4 " / CLICK-
72021004	INTAKE TUBE ASSY - LIVEWELL	79050061	CASSETTE PLUG/i- SERIES
72021005	STRAP SET - LIVEWELL	79050211	DRAIN PLUG - i /LIVEWELL / '10-
72021006	BATTERY LID - LIVEWELL	79050212	O-Ring .299ID x .505OD Neopren
72021007	PUMP CONNECTOR FEMALE - LIVEWE	79050400	i - WRENCH-MIRAGE DRIVE SS
72021008	PUMP CONNECTOR MALE - LIVEWELL	79052000	i - ACCESSORY HOLDER KIT
72021009	DOWNSPOUT FITTING - LIVEWELL	79052001	i - CUP HOLDER KIT
72021010	INTAKE 90 DEGREE - LIVEWELL	79052003	i - INFLATION PUMP / STANDARD
72021011	INSTALLATION PAD, FISHFINDER	79052005	i - INFLATION PUMP / ELECTRIC
72021020	DOWNSPOUT TUBE - LIVEWELL	79052006	i - HARDWARE ACCESSORY KIT
72021021	TERMINAL COVER - LIVEWELL	79052007	i - SEATBACK
72021022	PUMP ATTWOOD - LIVEWELL	79052009	i - HULL REPAIR KIT
72021023	INTAKE TUBE 7" ONLY - LIVEWEL	79052010	i - ROLLING TRAVEL BAG/ i - 12
72021031	EVOLVE CABLE KIT (2ND HULL)	79052011	i - ROLLING TRAVEL BAG/ i - 14
72021060	HORIZONTAL ROD HOLDER KIT	79052012	i - ROLLING TRAVEL BAG/ i - 9
72021108	PROP, HOBBIE DESIGN, TORQ MOTOR	79052013	i - O RING LG - INFLATION PUM
72021113	THRU HULL FITTING, PWR PLUG, V	79052014	i - O RING SM - INFLATION PUMP
72021114	BACKING RING, PWR PLG THRU HUL	79052015	i - TRI RING KIT / SAGE
72021115	MNTG PLT, M12 CABLE GLAND	79052016	i - TRI RING KIT / SUNDANCE
72021116	BACKING RING, MNTG PLT, M12 CA	79052017	i - VALVE ASSEMBLY
72021119	GASKET PACK, CABLE MOUNTS	79052018	i - GLUE 30g TUBE
72021120	CAP, PWR PLUG, FEMALE	79052019	i - PADDLE HOLDER
72021122	LANYARD, TYCO CNCTR CAP V1	79052202	i - SAIL KIT TURQ/PAPAYA
72021123	CAP, M12 CNCTR, FEMALE CVR	79052203	i - SAIL KIT WHITE-TURQ
72021124	CAP, M12 CNCTR, MALE CVR	79052204	i - SAIL KIT SILVER-WHITE
72021128	CAP ASSY POWER PLUG MALE	79052251	SAIL KAYAK MAST 4-PC
72021130	MOTOR W/225 PROPELLER,	79501001	DAGGERBOARD WELL PLUG - ADV
72021132	CHARGER - eVolve BATTERY	79502001	DAGGERBOARD / ADV - MOLDED
72021133	REMOTE THROTTLE, TORQUEEDO	79509001	SAIL ADV ISL WHT/GRAY/WHT
72021134	CABLE, POWER EXTENSION, 170"	79510001	MAST - ADV ISLAND '07 / MALE
72021135	CABLE, M12, THROTTLE BOX CONEC	79510011	MAST - ADV ISLAND '08 / FEM
72021136	CABLE, M12, THROTTLE CONTROL	79510201	BAG - ADV ISLAND MAST / SAIL
72021137	KEY W/LANYARD AND CLIP	79510202	BAG - TANDEM ISLAND MAST/SAIL
72022030	EVOLVE v2 MOTOR KIT - K	79510721	MOUNT XBAR V2 - TOP
72022031	EVOLVE v2 CABLE KIT (2ND HULL)	79510731	MOUNT XBAR V2 - BOTTOM
72022040	EVOLVE v2 MOTOR KIT - i	79511001	BASE / PIN - ISLAND MAST
72022130	EVOLVE v2 MOTOR W/225 PROPELLE	79511021	MAST CAP - ISLAND (SWIVEL TIP)
72022131	EVOLVE v2 BATTERY	79511101	BASE / HOLE - '08 ISLAND MAST

OS

OS

OS

AH

AH

AH

INDEX

79512001	DRUM - ISLAND MAST FURLER		81129001	SPROCKET V2 - THREADED W/GUARD
79512201	AKA AI V2 - RT FWD		81129022	V2 SPROCKET / MAST KIT STD (PA
79512301	AKA AI V2 - LT FWD		81129122	V2 SPROCKET / MAST KIT TURBO (
79512401	AKA AI V2 - LT REAR		81130001	SPROCKET MIRAGE - STAINLESS
79512501	AKA AI V2 - RT REAR		81155001	BOLT DRUM/CRANK
79512601	XBAR AI V2 - FWD		81160001	MAST, MIRAGE DRIVE, STD (UNIVE
79513001	BACKING RING, AI MAST RECEIVER		81163001	MAST - V2 STANDARD - THREADED
79514001	MAST RECEIVER, ADV ISL (FIBER)		81171001	DRUM PLASTIC MIRAGE
79514101	MAST RECIVER CUP ASSY AI '08		81172001	DECAL, PEDAL ADJUSTMENT
79515001	SAIL ADV ISL RED/GRAY/WHIT	OS	81173001	DRUM - V2
79516001	SAIL ADV ISL TURQ/PAPAYA/WHIT	OS	81181001	SPINE MIRAGE DRIVE - PLASTIC
79517001	V-FRAME, STRUT		81190001	FIN - MIRAGEDRIVE STANDARD
79518001	V-FRAME, BASE		81192001	MIRAGE ST TURBO FIN (W/PIN & R
79519001	V-FRAME, TURNBUCKLE-BRASS		81193001	MIRAGE ST FIN (w/PIN & RING)
79520001	AKA - FWD AI		81198001	MAST - ST TURBO FIN/UNIVERSAL
79520201	COLLAR - AKA		81198101	MAST - V2 ST TURBO - THREADED
79520211	AKA, RT FWD - TI		81201001	MIRAGEDRIVE CHAIN ASSY MIRAGE
79520301	END CAP - AKA		81202001	CHAIN ASSY, MIRAGEDRIVE V2
79520311	AKA, LT FWD - TI		81203001	IDLER CABLE, MIRAGEDRIVE V2
79520401	AKA, LT REAR - TI		81211001	IDLER CABLE ASSY (14 3/4) MIRA
79520501	AKA, RT REAR - TI		81212001	IDLER CABLE ASSY (14 1/4") MIR
79521001	AKA - LEFT/REAR AI		81221001	PEDAL / CRANK ASSY LEFT
79522001	AKA - RIGHT/REAR AI		81221011	PEDAL REPLACEMENT LEFT
79522201	LOCK BEARING, AKA XBAR		81222001	PEDAL / CRANK ASSY RIGHT
79523001	SOCKET - AKA BRACE LOCK		81222011	PEDAL REPLACEMENT RIGHT
79523101	BRACE ASSY (L) AKA AI V1 -22"		81222101	CAP - PEDAL CRANK
79523102	BRACE ASSY (R) AKA AI V1 -22"		81226001	PEDAL STRAP REPLACEMENT RIGHT
79523201	BRACE ASSY (L) AKA AI V2 -23"		81227001	PEDAL STRAP REPLACEMENT LEFT
79523202	BRACE ASSY (R) AKA AI V2 -23"		81230001	PEDAL ADJUSTMENT PIN
79524001	CAP - AKA BRACE LOCK		81236001	PEDAL ADJUST HANDLE ASSY
79525001	BALL - AKA BRACE		81240001	ADJUSTMENT HANDLE (OSP)
79526001	BAG - AKA CARRY - AI		81242001	SPRING COMPRESSION 1-1/4" LNG
79526002	BAG - AKA CARRY - TI		81245001	ROLL PIN 1/8 x 1-1/4 (420 SS)
79526201	ISLAND PADDLE / AKA BRACE KIT		81259001	SEAT STRAP w/HOOK
79526211	PADDLE STORAGE WEB ASSY		81265001	PLUG-IN SEAT PEG (OLDER)
79527001	TRAMP SET AI - BLACK		81265101	PLUG-IN SEAT CONNECTOR KIT ADJ
79527011	TRAMP SET AI - GREY		81266001	BACKREST MIRAGE 2009
79527101	LACING ROD - AI TRAMP		81266011	SEATBACK GEAR PACK
79527201	TRAMP AI - WEB/BUCKLE ASSY		81267001	HOOK, KAYAK SEAT
79528001	SCREW 1/4-20 X 1-1/4 SCKT SET		81268001	KAYAK BACKREST MIRAGE 2010
79530001	XBAR - REAR ASSY AI		81340001	BUSHING - STAINLESS SPROCKET
79530201	XBAR, REAR - TI		81350001	RUDDER MOUNT-MIR
79531001	XBAR - FWD ASSY AI		81360001	RUDDER PIN MIRAGE S.S.
79531101	CLEAT SUPPORT WEDGE w/FAIRLEAD		81361001	RUDDER MOUNT PIN MIR 4-1/2"
79531111	CLEAT SUPPORT WEDGE		81362001	RUDDER MOUNT PIN TDM/OUT/SPT
79531201	XBAR, FWD - TI		81370001	STEERING CRANK
79532001	SPRING ASSEMBLY, ISLAND ADV		81372001	STEERING CRANK ADV/OUTFITTER
79533001	BEARING PLATE, MAST FURLER		81375001	COMPRESSION SPRING (1)
79535001	CONNECTION PIN, AKA/XBAR		81380001	CONTROL ARM - UP/DOWN
79536001	CONNECTOR, AKA BRACE		81385001	WASHER 13/16 EDPM RUBBER
79537001	CLIP, ISLAND AKA BRACE KIT (2)		81390001	RUDDER MIRAGE - ORIGINAL STYLE
79538001	PADDLE CLIP, ISLAND XBAR		81391002	RUDDER UP/DOWN LINE SYSTEM
79538101	ISLAND PADDLE HOLDER KIT		81391011	GUDGEON, T-N-S RDR (UAI)
79538201	PULL TAB - WEBBING LOOP		81392001	CONTROL ARM, TWIST-N-STOW RDR
79545001	DECAL, HOBIE DOME, BLK/GRAY		81393001	THUMB SCREW 1/4-20 BLK NYLON
80010001	MIRAGE DRIVE		81394001	RUDDER PIN, TWIST N' STOW RDR
80010201	MIRAGEDRIVE SPARE PARTS KIT		81394021	RUDDER PIN, TWIST N' STOW 2011
80010301	MIRAGEDRIVE "V2" SPARE PARTS K		81395001	RUDDER ASSY W/SM BLADE - TWIST
80012001	PEDAL RETAINER BUNJEE ASSY		81395201	RUDDER BLADE - SMALL / TWIST-N
80013001	MIRAGE DRIVE - ST TURBO		81396001	RUDDER ASSY W/LRG BLADE - TWIS
80013011	MIRAGE DRIVE - i SERIES		81397001	RUDDER BLADE - LARGE / TWIST-N
80013201	MIRAGEDRIVE TURBO SPARE PARTS		81397101	i / QUEST - RUDDER BLADE - LAR
80013301	MIRAGEDRIVE "V2" TURBO SPARE P		81399001	BOLT TWIST-N-STOW DRUM
80020001	LINE KIT MIRAGE RUDDER / UNIVE		81400001	TUBING HI-DENSITY PE
80025001	LINE CONTROL ASSY - (1) LINE A		81405001	STEERING TUBE HOLDER (UAI)
80030001	SPEEDOMETER MIRAGE DRIVE		81405101	CAP - STEERING TUBE "O" RETAIN
80044021	HOBIE-TRAX CART FRAME		81406001	DECAL / HANDLE - UP
80044031	HOBIE-TRAX CART PAD		81407001	DECAL / HANDLE - DOWN
80044051	HOBIE-TRAX HUB LOCK KNOB		81408001	HANDLE, RUDDER PULL CORD
80044101	HOBIE TRAX "2" CART PLUG-IN		81410001	CAM LOCK KNOB
80044111	HOBIE TRAX "2" WHEEL REPLACE		81420001	SPROCKET GUARD URE
80044201	CART POST COLLAR/CLAMP KIT		81450001	CHEEK BLOCK - HOBIE
80045000	CAP - HOBIE CART DOME		81535001	CASSETTE PLUG-BLK (UAI)
80045001	HOBIE STANDARD PLUG-IN CART		81602101	SPRING CLICK-N-GO LEFT
80045041	HOBIE STANDARD CART - WHEEL		81602201	SPRING CLICK-N-GO RIGHT
80045101	i - HOBIE PLUG-IN CART / STAND		81611101	CLICK-N-GO ASSY LEFT/PORT
80046001	HOBIE HVY DUTY PLUG-IN CART		81611201	CLICK-N-GO ASSY RIGHT/STBD
80046041	HOBIE HVY DUTY CART-WHEEL		82300001	HOBIE STUFF
80048001	ROD HOLDER-BAIT CASTER w/LABEL		84431001	DVD / HOBIE - FISH THE WORLD
80048002	ROD HOLDER HEIGHT EXTENDER 8.5		84500001	SEAT ASSEMBLY - PRO ANGLER
80048003	ROD HOLDER HEIGHT EXTENDER 6.5		84500011	LUMBAR PAD PRO ANGLER
80048004	ROD HOLDER w/ SIDE/DECK MOUNT		84500021	SEAT STRAP ASSY - PRO A
80048005	ROD HOLDER-ROCKET LAUNCHER		84500101	RUDDER BLADE, PRO A
80048006	GEAR HEAD MOUNT		84500201	RUDDER HOUSING, UNDER HULL
80049001	FLUSH DECK MOUNT, BLK		84500401	RDR MOUNT, UNDER HULL
80052001	SIDE/DECK MOUNT, BLK		84500501	RDR STEERING DRUM
80055001	ROD HOLDER-FLY w/DECK MNT		84500601	COVER PLT, RDR SYSTEM
80074001	STEERING LINE TUBE 68" (Pro A)		84500801	STEERING TUBE RESTRICTOR
81013001	STEERING HANDLE 2011 STD LENGT		84500911	ROD HOLDER ASSY (L) - PRO A
81015001	STEERING HANDLE ASSY MIRAGE		84500921	ROD HOLDER ASSY (R) - PRO A
81023001	LINE-CONTROL 1.75 MM		84501001	B/U PLATE, ROD HOLDER
81030001	ZIP TIE, 6-5/16", BLK NYLON		84501101	GASKET, ROD HOLDER PLT
81035001	RUDDER UP/DOWN HANDLE ASSY W/S		84501201	THRU HULL BARB CONNECTOR
81035011	HANDLE - UP/DOWN RETRO KIT		84501301	HANDLE, STEERING SYSTEM
81037001	DRIVE SEAL / MIRAGE DRIVE		84501401	HOUSING, STEERING SYSTEM
81038001	DRIVE SEAL / i - MIRAGE DRIVE		84501511	KNOB, STEERING TENSION
81040001	OUTHAUL BLOCK (STNLS SPKT)		84501521	WASHER, 3/16x 1/2 OD, RUBBER
81050001	OUTHAUL BLOCK (INJ/MOLD)		84501531	BALL, STEERING SYSTEM, PRO A
81055001	SPROCKET GUARD FWD (INJ/MLD)		84501601	TUBE CONNECTOR, STEERING
81080001	SPROCKET SHAFT MIRAGE		84501901	HATCH LINER FWD - PRO ANGLER
81090001	DRUM SHAFT MIRAGE		84502001	MOUNTING BRD, RT, BLK
81100001	CRANK LEFT MIRAGE (THREADED)		84502101	MOUNTING BOARD, LT
81105001	CRANK RIGHT MIRAGE (THREADED)		84502201	CUTTING BRD, CNTR, BLACK
81110001	SHAFT #5 MIRAGE		84502301	SISTER SCREW, PRO RDR ASSY
81121001	IDLER PULLEY (PLASTIC DRUM)		84502401	FLOOR MAT PRO A - RT BLK
81128001	SPROCKET W/SET SCREW (INJ/MLD)		84502501	FLOOR MAT PRO A - LT BLK

INDEX

84502601	STEERING TENSION SCREW		3855LG	HOBBIE - SHORTY 2/2 LG BLACK
84502901	KNOB, SEAT FRONT		3855MD	HOBBIE - SHORTY 2/2 MD BLACK
84504001	TORSION SPRING, RUDDER		3855SM	HOBBIE - SHORTY 2/2 SM BLACK
84504101	SIDE HANDLE ASSY - UNIVERSAL		3855XL	HOBBIE - SHORTY 2/2 XL BLACK
84504201	TUBE, STERN HANDLE		3856LG	HOBBIE - FULL 3/2 LG BLACK
84504301	DECAL, RULER		3856MD	HOBBIE - FULL 3/2 MD BLACK
84504401	HANDLE END FITTING		5018BK	HAT HOBBIE "H" BLACK
84504501	HANDLE BOW - PRO ANGLER		5018BL	HAT HOBBIE "H" BLUE / GOLD
84505001	STORAGE BUCKET ASSY		5018GM	HAT HOBBIE "H" GREY MESH
84505101	STORAGE BUCKET COMPARTMENT		5018RM	HAT HOBBIE "H" RED MESH
84505201	STORAGE BUCKET COMPARTMENT DIV		5018TG	HAT HOBBIE "H" TAN w/ GREEN LOG
84506001	STEERING ASSEMBLY (Pro A)		5019BK	HAT "HOBBIE" 6-PANEL LO PRO BLK
84506201	STEERING (PRO A) REVERSIBLE AS		5022FK	HAT - FISH FLEXFIT KHAKI
84509001	BATTEN CAP 1/8 DIA - KAYAK SAI		5022FO	HAT - FISH FLEXFIT OLIVE
84513001	SAIL KIT KAYAK TURQ/PAPAYA	OS	5022TK	HAT - FISH TRUCKER KAHKI
84514001	SAIL KIT KAYAK WHITE/RED	OS	5022TO	HAT - FISH TRUCKER OLIVE
84515001	SAIL KIT KAYAK WHITE/TURQ	OS	5023PP	HAT-PERFORMANCE CAP PUMPKIN
84516001	SAIL KIT KAYAK SILVER/WHITE	OS	5023TO	HAT-TWILL CAP OAR WASHED
84550001	MAST RECEIVER - MIRAGE KAYAK S		5023TS	HAT-TRUCKER BOA GREEN/STONE
84560001	CAP, PLASTIC MAST RECEIVER		5023VS	HAT-VISOR STONE WASHED TWILL
84965001	DOWNHAUL HOOK-SAIL ADAPTOR		5129LG	T-SHIRT KAYAK LG BLK
86000001	OWNER'S MANUAL-MIRAGE		5129MD	T-SHIRT KAYAK MD BLK
88523101	BRACE ASSY (L) AKA TI -22"		5129XL	T-SHIRT KAYAK XL BLK
88523102	BRACE ASSY (R) AKA TI -22"		5130LG	T-SHIRT KAYAK LG GREY
88527001	TRAMP SET TI - BLACK		5130MD	T-SHIRT KAYAK MD GREY
88527011	TRAMP SET TI - GREY		5130XL	T-SHIRT KAYAK XL GREY
88536001	CONNECTOR, AKA BRACE TI		5131LG	T-SHIRT FISHING LG
88991001	CENTERBOARD TDM ISLAND		5131MD	T-SHIRT FISHING MD
88991011	CENTERBOARD TOP CVR-TDM ISLAND		5131XL	T-SHIRT FISHING XL
88991021	CENTERBOARD PIN-TDM ISLAND		5131XXL	T-SHIRT FISHING XXL
88991031	PIN HOLDER-TDM ISLAND		5351B	HATCH COVER KIT 5" BLACK
88991041	KNOB-TDM ISLAND		5351W	HATCH COVER KIT 5" WHITE
88991061	SIDE CARRY HANDLE-TDM ISLAND		72000B	POUCH GUSSETED 6x12
88991071	FURLER DRUM - TDM ISLAND		72005B	POUCH SUPER GUSSETED 8x15
88991094	GUDGEON, AI/TI		72210T	SEE BAG 8" X 14"
88991101	RUDDER PIN-TDM ISLAND		72230T	SEE BAG 11" x 19"
88991121	MAST-TDM ISLAND (550 CM)	OS	80035A	ANCHOR w/BAG & LINE (3 LB)
88991150	KNOB CAP-TDM ISLAND		H071	SPRING-STANDUP
88991151	DOVE DECAL LG HANDLE, H LOGO		H082	BLOCK-SINGLE BULLET
88991152	DOVE DECAL SM HANDLE - H LOGO		H083	BLOCK-BULLET W/BECKET
88991185	RUDDER ASSY TI		H092	BLOCK-BULLET CHEEK
88991187	RUDDER BLADE TI		H166	BLOCK-BULLET SWIVEL
88991191	V-FRAME STRUT 3/8-TDM ISLAND		H167	BLOCK-BULLET SWIVEL W/BECKET
88991201	V-FRAME BASE 3/8-TDM ISLAND		H224	BLOCK-MICRO SINGLE
88991235	DOWEL PIN 3/16 x 1-1/2"		H225	BLOCK-MICRO W/BECKET
88991281	STEERING CRANK, AI/TI (2011)		H233	BLOCK-MICRO CHEEK
88991301	STEERING HANDLE-TDM ISLAND (UA)		H2655	BLOCK, 40mm CARBO FIDDLE
88991303	AMA - TDM ISLAND PAPAYA		H281	EYESTRAP-MICRO SS
88991304	AMA - TDM ISLAND HIBISCUS		H284	KIT-MICRO WIRE FAIRLEAD
88991305	AMA - TDM ISLAND DUNE		H297	WEDGE KIT-MICRO CAM
88991351	KNOB - STEERING HANDLE		H350	29mm CARBO CHEEK
88991352	KNOB CAP		H404	BLOCK-16MM AIR FXD SGL
88991355	KNOB ASSY. STEERING HANDLE		H405	BLOCK-16MM AIR FIXED SGL W/BKT
88998514	SAIL-TDM ISLAND (FOR DUNE)		H406	BLOCK-16MM AIR FIXED DOUBLE
88998515	SAIL-TDM ISLAND SMOKE		H407	BLOCK-16MM AIR FIXED DBL W/BKT
88998516	SAIL-TDM ISLAND BREEZE		H424B	FAIRLEAD MICRO CAM - BLK
88998521	BATTEN TI #1 3/8" x 186" W/CAP		H427	CAM-MICRO CARBO W/WIRE FAIRLEA
88998522	BATTEN TI #2 3/16" x 42.5" W/		H471	CAM CLEAT-MICRO CARBO
88998523	BATTEN TI #3 3/16" x 39.5" W/		RF4850LG	GLOVES-FINGERLESS LG STICKY
88998531	BATTEN CAP 1/4 DIA		RF4850MD	GLOVES-FINGERLESS MD STICKY
88999519	BATTEN CAP 3/8 DIA (UAI)		RF4850SM	GLOVES-FINGERLESS SM STICKY
89000001	OWNER'S MANUAL-MIRAGE SPORT		RF4850XL	GLOVES-FINGERLESS XL STICKY
89500001	OWNER'S MANUAL-ADVENTURE/OUTFI		RF4850XS	GLOVES-FINGERLESS XS STICKY
90610111	DELRIIN BALL 3/8 DIA - FURLERS		RF4851LG	GLOVES-3 FINGER LG STICKY
91011001	BATTEN CAP 3/16 DIA		RF4851MD	GLOVES-3 FINGER MD STICKY
91041011	BATTEN 3/16 FG ROD, 7' 8-1/2"		RF4851SM	GLOVES-3 FINGER SM STICKY
91050010	HOOK WHT NYLON SEW-ON		RF4851XL	GLOVES-3 FINGER XL STICKY
91050020	HOOK BLK NYLON SEW-ON		RF4851XS	GLOVES-3 FINGER XS STICKY
91051011	BATTEN 3/16 FG ROD, 9' 2"		RH014WHT	LINE 1/4" STRAIT-CORE POLY
99303001	ISLAND AMA REPL-PAPAYA	OS	RH018WHT	LINE 1/8" NYLON BRAID WHITE
99304001	ISLAND AMA REPL-HIBISCUS	OS	RH038WHT	LINE 3/8" STRAIT-CORE POLY
99305001	ISLAND AMA REPL-DUNE	OS	RH112WHT	LINE 1/12" NYLON BRAID WHITE
99403001	ISLAND AMA KIT - PAPAYA	OS	RH316WHT	LINE 3/16" STRAIT-CORE POLY
99404001	ISLAND AMA KIT - HIBISCUS	OS	RH516WHT	LINE 5/16" STRAIT-CORE POLY
99405001	ISLAND AMA KIT - DUNE	OS	RM014BLK	LINE 1/4" SPUN DACRON - BLACK
99503001	ISLAND CONVERSION KIT - PAPAYA	OS	RM014BLU	LINE 1/4" SPUN DACRON - BLUE
99504001	ISLAND CONVERSION KIT- HIBISCU	OS	RM014RED	LINE 1/4" SPUN DACRON - RED
99505001	ISLAND CONVERSION KIT - DUNE	OS	RM014WHT	LINE 1/4" SPUN DBL BRD - WHITE
99600001	INSTALL TOOLS - MAST HOLE SAW		RM038BLK	LINE 3/8" SPUN DACRON - BLACK
99603001	ISLAND SAIL KIT - YELLOW-WHT	OS	RM038BLU	LINE 3/8" SPUN DACRON - BLUE
99604001	ISLAND SAIL KIT - RED-WHT	OS	RM038RED	LINE 3/8" SPUN DACRON - RED
99605001	ISLAND SAIL KIT - SILVER-WHT	OS	RM038WHT	LINE 3/8" SPUN DBL BRD - WHITE
1553CR	CROAKIES "HOBBIE"		RM516BLK	LINE 5/16" SPUN DACRON - BLK
1553L	LID LATCH MULTI-COLOR		RM516BLU	LINE 5/16" SPUN DACRON - BLUE
1562BLK	SUNGLASS HOBBIE PLAYA BLACK		RM516RED	LINE 5/16" SPUN DACRON - RED
1564BLK	SUNGLASSES HOBBIE BOOMER BLACK		RM516WHT	LINE 5/16" SPUN DBL BRD-WHITE
1565BLK	SUNGLASSES HOBBIE ESCONDIDO		RM716BLK	LINE 7/16" SPUN DACRON - BLACK
1825WHT	TOYBOX	OS	RM716BLU	LINE 7/16" SPUN DACRON - BLUE
3187LG	GLOVES - FULL FINGER LARGE		RM716RED	LINE 7/16" SPUN DACRON - RED
3187MD	GLOVES - FULL FINGER MEDIUM		RM716WHT	LINE 7/16" SPUN DACRON - WHITE
3187SM	GLOVES - FULL FINGER SMALL		RS014BLK	SHOCKCORD 1/4" BLACK
3187XL	GLOVES - FULL FINGER X LARGE		RS018BLK	SHOCKCORD 1/8" BLACK
3187XS	GLOVES - FULL FINGER X SMALL		RS038BLK	SHOCKCORD 3/8" BLACK
3187XXS	GLOVES - FULL FINGER XX SMALL		RS316BLK	SHOCKCORD 3/16" BLACK
3188LG	GLOVES HOBBIE LARGE		RS516BLK	SHOCKCORD 5/16" BLACK
3188MD	GLOVES HOBBIE MEDIUM		RS716BLK	SHOCKCORD 7/16" BLACK
3188SM	GLOVES HOBBIE SMALL		S6142LG	PFD WEDGE-E LG
3188XL	GLOVES HOBBIE X LARGE		S6142MD	PFD WEDGE-E MD
3850LG	HOBBIE SPRAY TOP LG		S6142SM	PFD WEDGE-E SM
3850SM	HOBBIE SPRAY TOP SM		S6142XL	PFD WEDGE-E XL
3853LG	HOBBIE - SHORTY 2/2 LG RED/BLK		S6142XXL	PFD WEDGE-E XXL
3853MD	HOBBIE - SHORTY 2/2 MD RED/BLK		S6143LXL	PFD HI-BACK ZIP MANGO LXL
3853SM	HOBBIE - SHORTY 2/2 SM RED/BLK		S6143SMD	PFD HI-BACK ZIP MANGO SMD
3853XL	HOBBIE - SHORTY 2/2 XL RED/BL		S6143XXL	PFD HI-BACK ZIP MANGO XXL
3854LG	HOBBIE - FULL 3/2 LG RED/BLK		S6144LXL	PFD HI-BACK ZIP GREEN LXL
3854XL	HOBBIE - FULL 3/2 XL RED/BLK		S6144SMD	PFD HI-BACK ZIP GREEN SM

INDEX

S6144XXL	PFD HI-BACK ZIP GREEN XXL
S6145LXL	PFD HIBACK MANGO LXL -ULC
S6145SMD	PFD HIBACK MANGO SMD -ULC
S6146MLG	PFD HI-BACK P-BLUE (W) MLG
S6146PS	PFD HI-BACK P-BLUE (W) PS
S6146XSS	PFD HI-BACK P-BLUE (W) XSS
S6147MLG	PFD HI-BACK MANGO (W) MLG
S6147PS	PFD HI-BACK MANGO (W) PS
S6147XSS	PFD HI-BACK MANGO (W) XSS
S6148LXL	PFD FISHERMAN MANGO LXL
S6148SMD	PFD FISHERMAN MANGO SMD
S6148XXL	PFD FISHERMAN MANGO XXL
S6149LXL	PFD FISHERMAN CACTUS LXL
S6149SMD	PFD FISHERMAN CACTUS SMD
S6149XXL	PFD FISHERMAN CACTUS XXL
S6779R	PFD INFLATABLE REARM KIT
S6779RG	PFD INFLATABLE RED/GRAY
S6779TG	PFD INFLATABLE TAN/GRAY

S6780RG	PFD BELT PACK INFLATABLE RED/G
SBV3120YEL	PFD CHILD (30-50LB) RED
SBV3122YEL	PFD YOUTH (50-90LB) RED
SP150041	SHACKLE 5/32 X 3/8 X 5/8
SP150051	SHACKLE 3/16x1/2x11/16
SP150052	SHACKLE 3/16 x 5/8 x 5/16
SP150053	SHACKLE 3/16 X 5/8 X 1-7/16
SP150061	SHACKLE 1/4x9/16x15/16
SP170005	SHACKLE TWISTED SS 3/16
SP170006	SHACKLE TWISTED SS 1/4
SP180005	SHACKLE KEY PIN 3/16"
SP180006	SHACKLE KEY PIN 1/4"
SP185205	SHACKLE KEY PIN 3/16"
V1093	SCREW-IN DECKPLATE 5" CRVD WH
V1130	SCREW-IN DECKPLATE 4" CRVD WH
V1131	SCREW-IN DECKPLATE 4" CRVD BL
V1145	SCREW-IN DECKPLATE 6" WHITE W
V1146	SCREW-IN DECKPLATE 6" BLACK W/

Serious Fun

POWERED BY



HOBIE
MirageDrive®

It's Mother Nature's Show—But We Make the Front Row Seats.

Propelled by the patented MirageDrive,[®] Hobie's pedal-driven Mirage line of sit-on-top kayaks leaves your hands free for binoculars, a camera or a cool drink.

The MirageDrive employs twin underwater "flippers" that work much like a penguin's fins. The back-and-forth motion from each pedal cycle propels the boat smoothly, effortlessly and virtually silently. And the best part—no noisy paddles to scare away the wildlife.

Hobie Mirage Kayaks are available in single and tandem models, in both rigid and inflatable styles.

From the Everglades to the shoreline of Puget Sound, Hobie has the perfect kayak for your next adventure.



hobie kayaks.com



HOBIE CAT COMPANY

Oceanside, California U.S.A.
1-800-HOBIE-49
hobiecat.com

HOBIE CAT AUSTRALASIA

Huskisson, New South Wales Australia
1-800-4-HOBIE
hobiecat.com.au

HOBIE KAYAK EUROPE

Stellendam, The Netherlands
+31 (0) 187 499 440
hobie-kayak.com



PARTS & ACCESSORIES

87367003